

AGRIMATE BRUSH CUTTER AM-3000-BC-2S-WC-PRO



INTRODUCTION

Dear Sir/ Madam,

Thank you for choosing Agrimate product. You are the proud owner of high technology & durable machine. Trust that our Franchisee/Dealer installed the product & installed the product and explained you about the usage & service instructions. Please visit our autorised dealer for your future requirement of our other equipments, genuine spares, accessories and services. Service coupons are attached with this manual and you can avail free service to keep your machine fit always to use on demand.

About Ratnagiri,

We import and market of high quality of agriculture wide range of equipments which we are selling through our authorised franchisee or dealer network. We are in this field from past years service the farmer. community. For further details, Please visit our website www.agrimart.in. & Give a missed call to **7393 938 938**

TECHNICAL SPECIFICATIONS

| | |
|--------------------|---------------------------------|
| STROKE | 2-STROKE |
| ENGINE | SINGLE CYLINDER AIR COOL ENGINE |
| DISPLACEMENT | 26CC |
| ENGINE POWER | 0.65KW/6500RPM |
| FUEL TANK CAPACITY | 0.65LTR |
| CARBURETOR | DIAPHRAM TYPE WALBRO |
| STARTING SYSTEM | RECOIL STARTER |
| IGNITION MODE | CDI |
| STOP MODE | SWITCH STOP |
| AIR CLEANER | SPONGE |
| SPARK PLUG | TORCH |
| HANDLE POLE | 19mm(Diameter)*1.5mm(Thinkness) |

MAINTENANCE & CARE

Fuel filter

- Fuel tank is fitted with a filter. Filter is situated at the free end of fuel pipe and can be picked out through fuel port with a piece of hooked wire or the link.
- Check the fuel filter periodically. Do not allow dust to enter into fuel tank. Clogged filter will cause difficulty in starting engine or abnormalities in engine performance.
- When filter is dirty, replace the filter.
- When the inside of the fuel tank is dirty, it can be cleaned by rinsing the tank out with gasoline.

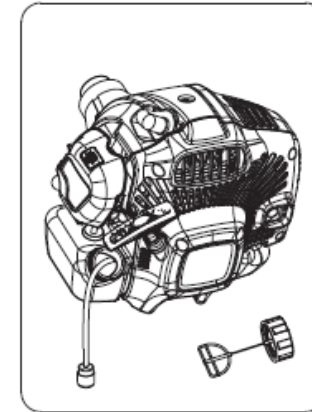

Spark plug

- Do not attempt to remove the plug from a hot engine in order to avoid possible damage to the threads.
- Clean or replace the plug if fouled with heavy oily deposits.
- Replace the plug if the center electrode is worn rounded at the end.
- Spark gap 0.6-0.7mm (.023".028")
- Fastening torque =14-15Nm(125-135in.lb)

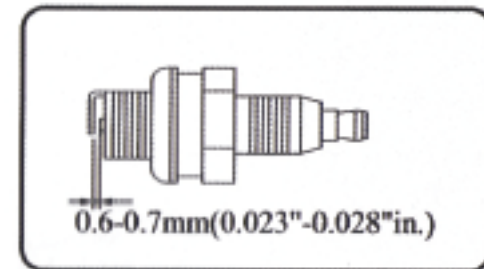

Bevel gear

After working (40-50) hours, fill with the right quantity of grease. Remove the screw and put in the lithium-based grease. turning the shaft manually until grease emerges, then refit the wash the screw.



WARNING  **CAUTION**

Use only original manufacturer's replacement parts, accessories and attachments. Failure to do so can cause possible injury, poor performance and may void your warranty.

EXHAUST PORT AND SILENCER

• Depending on the type of fuel used, the type and amount of oil used, and/or your operating conditions, the exhaust port and silencer may become blocked with carbon deposits. If you notice a power loss with your petrol-powered tool, a qualified service technician will need to remove these deposits to restore performance.

outside cover

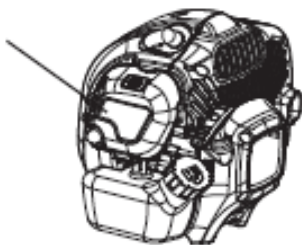

- The cutting attachment must not rotate in idle mode. If this requirement is not satisfied, the clutch has to be adjusted or the machine needs an urgent maintenance by a qualified technician.
- You may make adjustments and repairs described here. For other repairs, have the trimmer serviced by an authorized service agent.
- Consequences of improper maintenance may include excess carbon deposits resulting in loss of performance and discharge of black oily residue dripping from the muffler.
- Make sure all guards, straps, deflectors and handles are properly and securely attached to avoid the risk of personal

AIR FILTER

- Accumulated dust in the air filter will reduce engine efficiency. Increase fuel consumption and allow abrasive particles to pass into the engine. Remove the air filter as often as necessary to maintain in a clean condition.
- Light surface dust can readily be removed by tapping the filter. Heavy deposits should be washed out in suitable solvent.
- Remove filter cover by push the button



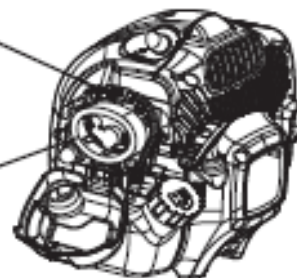

push the button

filter net

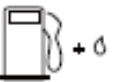

ADJUSTING CARBURETOR NOTE

Do not adjust carburetor unless necessary. If you have trouble with the carburetor, see your dealer. Improper adjustment may cause engine damage and void warranty. Some of the following symbols may be used on this tool. Please study them and understand their meaning. Proper interpretation of these symbols will allow you to operate the tool better and safer.

| SYMBOL | NAME | DESIGNATION/EXPLANATION |
|-------------------------------------------------------------------------------------|-----------------|----------------------------------------------------------------------------------------------------|
|  | Choke lever | choke (close) N , run (open) III |
|  | Ignition switch | |
|  | Fuel | Use unleaded petrol intended for motor vehicle use with an octane rating of 91([R+M]/2) or higher. |
| | | Use 2-stroke oil for air cooled engines. |
| | | Mix the fuel mix thoroughly and also each time before refuelling. |
|  | No Smoking | Do not smoke when mixing fuel or filling fuel tank. |

SAFETY RULES&PRECAUTIONS

Proper safety precautions must be observed. Like all power equipment this unit must be handled carefully. DO NOT EXPOSE YOURSELF OR OTHERS TO DANGER. Follow the general rules. Do not permit others to use this machine unless they are thoroughly responsible and have read, and understand the machine manual and are trained in its operation. This machine is not to be operated by children.

- Always wear safety goggles for eye protection. Dress properly, do not wear loose clothing or jewelry that could become caught in moving parts of the unit. Safe, sturdy, nonskid footwear should always be worn. Long hair should be tied back. It is recommended that legs and feet be covered to protect from flying debris during operation.
- Before using and after dropping or other impacts, inspect the entire machine for loose parts (nuts, bolts, screws, etc.) and any damage. Repair or replace as necessary.
- DO NOT USE any attachment with this power head other than the ones recommended by our company. Serious injury to the operator or bystanders could result as well as damage to the machine.
- Keep the handles free from oil and fuel.
- Always use proper handles and shoulder strap when cutting.
- Do not smoke while mixing fuel or filling tank.
- Do not mix fuel in an enclosed room or near open flames. Ensure adequate ventilation.
- Always mix and store the fuel in a properly marked container that is approved by local codes and ordinances for such usage.
- Never remove the fuel tank cap while the engine is running.
- Never start or run the engine inside a closed room or building. Fumes from the exhaust contain dangerous carbon monoxide.
- Never attempt to make engine adjustments while the unit is running and strapped to the operator. Always make engine adjustments with the unit resting on a flat, clear surface.
- Do not pull on the cable.
- Do not lift the machine other than by the handle of the shaft.
- Do not rest the machine on the ground while the engine runs (e.g. in idling).
- Regular check for damages, failing of parts, component or cables.

ENGINE STARTING AND STOPPING PROCEDURES

STARTING COLD ENGINE

1. Move the ignition switch to "START".
2. Give a gentle push on the primer pump repeatedly (7-10 times) until fuel comes into the primer pump.
3. Pull the choke lever up to close choke
4. Move the throttle trigger and keep it in position with the throttle lock (if present).
5. Pull starter handle until engine false fires.
6. Push choke lever inwards (excessive cranking with choke lever will cause flooding of engine making it difficult to start.)
7. Pull starter handle until engine starts.
8. When the engine is started, disconnect the starter by turning the choke lever to "RUN"
9. Disengage the throttle lock (if present) pressing the throttle trigger briefly.
10. Allow engine to warm up for a few minutes before using.

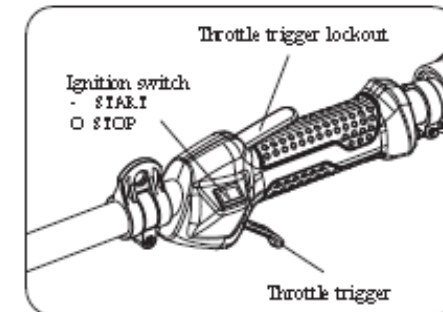
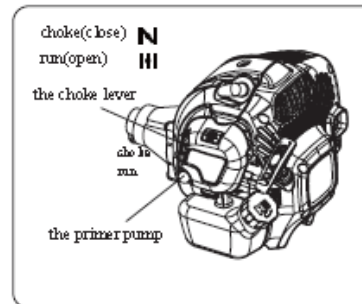
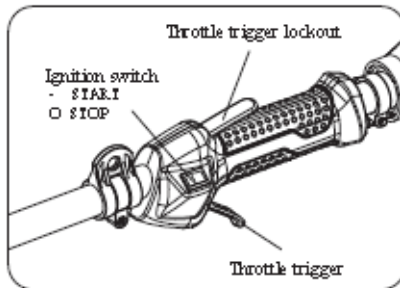

If the starter rope is pulled repeatedly with the choke on, it may flood the engine and make starting difficult.

If you have flooded the engine, remove the spark plug and gently pull the handle on the starter rope to eliminate any excess fuel; then dry the spark plug electrodes and replace it on the engine.

STARTING WARM ENGINE

The choke lever to the "RUN"

- If fuel tank was not run dry, pull starter one to three times and engine should start.
- If fuel tank was run dry, after refilling repeat steps 1-2-7

STOPPING THE ENGINE

- Release the throttle trigger and allow the engine to run idle for a few seconds.
- Move switch to STOP position.

PREPARING FOR OPERATIONS

WHEN MIXING GASOLINE WITH TWO CYCLE ENGINE OIL, USE ONLY GASOLINE WHICH CONTAINS NO ETHANOL OR METHANOL(TYPES OF ALCOHOL). THIS WILL HELP TO AVOID POSSIBLE DAMAGE TO ENGINE FUEL LINES AND OTHER ENGINE PARTS. DO NOT MIX GASOLINE AND OIL DIRECTLY IN THE ENGINE FUEL TANK.

IMPORTANT: Failure to follow proper fuel mix instructions may cause damage to the engine

1. When preparing fuel mixture, mix only the amount needed for the job you are to do. Do not use fuel that has been stored longer than two months. Fuel mixture stored longer than this will cause hard starting and poor performance. If fuel mix has been stored longer than this time, it should be removed and filled with fresh mixture.

WARNING DANGER

2. Never fill the fuel tank to the very top. (under 3/4 of the tank)
3. Never add fuel to the tank in a closed non-ventilated area.
4. Do not add fuel to this unit close to an open fire or sparks.
5. Be sure to wipe off spilled fuel before attempting to start engine
6. Do not attempt to refuel a hot engine.

WARNING DANGER

The engine exhaust from this product contains chemicals known to cause cancer, birth defects, or other reproductive harm.

CHECK POINTS BEFORE OPERATION

1. Check for loose bolts, nuts and fittings.
2. Check the air cleaner for dirt. Clean the air filter of all dirt, etc. before operation.
3. Check to be sure that protector is securely in place.
4. Check to be sure that fuel is not leaking.
5. Check to be sure that blade is not cracked.

SAFETY RULES & PRECAUTIONS

- Do not use the unit if it is damaged or poorly adjusted. Never remove the machine's guard. Serious injury to the operator or bystanders could occur as well as damage to the machine.
- Inspect the area to be cut and remove all debris that could become entangled in the nylon cutting head. Also remove any objects that the unit may throw during cutting.
- Keep children away. Onlookers should be kept at a safe distance from the work area, at least 15 METER (50 FEET).
- Never leave the machine unattended.
- Do not use this unit for any job other than those for which it is intended as described in this manual.
- Do not overreach. Keep proper footing and balance at all times. Do not run the unit while standing on a ladder or on any other unstable footing location.
- Keep hands and feet clear of the nylon cutting head while unit is in use.
- Do not use this type of machine for sweeping away debris.
- Do not use the unit when you are tired, ill or under the influence of medication, drugs or alcohol.
- Use nylon cutting head which is free of damage. If a stone or any other obstacle is hit, stop the engine and check the nylon cutting head. A broken or unbalanced nylon cutting head must never be used.

FOLLOW INSTRUCTION FOR CHANGING ACCESSORIES.

- Do not store in a closed area where fuel vapors can reach an open flame from hot water heaters, heaters, furnaces, etc. Store in a locked, well ventilated area only.
- Ensure safe and proper performance of your product. These part are available from your dealer. The use of any other accessories or attachments may cause a potential hazard or injury to the user, damage to the machine and void this warranty.
- Clean the machine completely, especially, the fuel tank, its surroundings, and the air cleaner.
- When refueling, be sure to stop the engine and confirm that it is cooled down. Never refuel when the engine is running or hot. When gasoline spills, be sure to wipe it up completely and properly dispose of those materials before starting the engine.
- Stay clear of other workers or bystanders by at least 15 meters /50 feet.
- When ever approaching an operator of the machine, carefully call his attention and confirm that the operator stops the engine. Be careful not to startle or distract the operator which can cause an unsafe situation.
- Never touch the nylon cutting head when ever the engine is running. If it is necessary to adjust the protector or nylon cutting head, be sure to stop the engine and confirm that the nylon cutting head has stopped running.
- The engine should be turned off when the machine is moved between work areas.
- Be careful not to hit the nylon cutting head against stones, or the ground. nreasonable rough operation will shorten the life of the machine as well as create an unsafe environment for yourself and those around you.

- Pay attention to loosening and overheating of parts. If there is any abnormality of the machine, stop operation immediately and check the machine carefully. If necessary, have the machine serviced by a authorized dealer. Never continue to operate a machine which may be malfunctioning.
- In start-up or during operation of the engine, never touch hot parts such as the muffler, the high voltage wire or the spark plug.
- After the engine has stopped, the muffler is still hot. Never place the machine in any places where there are flammable materials (dry grass, etc.), combustible gases or combustible liquids.
- Pay special attention to operation in the rain or just after the rain as the ground may be slippery.
- If you slip or fall to the ground or into a hole, release the throttle lever immediately.
- Be careful not to drop the machine or hit it against obstacles.
- Before proceeding to adjust or repair the machine, be sure to stop the engine and detach the spark plug cap from the spark plug.
- When the machine is placed in storage for a long time, drain fuel from the fuel tank and carburetor. clean the parts, move the machine to a safe place and confirm that the engine is cooled down.
- Make periodic inspections to assure safe and efficient operation. For a thorough inspection of your machine, please contact a dealer.
- Keep the machine away from fire or sparks.
- It is believed that a condition called Raynaud's phenomenon, which affects the fingers of certain individuals may be brought about by exposure to vibration and cold. Exposure to vibration and cold may cause tingling and burning sensations followed by loss of color and numbness in the fingers. The following precautions are strongly recommended because the minimum exposure which might trigger the ailment is unknown.
- Keep your body warm, especially the head, neck, feet, ankles, hands and wrists.
- Maintain good blood circulation by performing vigorous arm exercises during frequent work breaks and also by not smoking.
- Limit the hours of operation. Try to fill each day with jobs where operating the brush cutter or other hand-held power equipment is not required.
- If you experience discomfort, redness and swelling of the fingers followed by whitening and loss of feeling, consult your physician before further exposing yourself to cold and vibration.
- Always wear ear protection, as being exposed to loud noise for long time can result in diminished hearing or even loss of hearing. Total face and head protection must be worn to prevent bodily injury from either slipping or falling into shrubbery, branches, or bushes.
- Wear no-slip heavy duty work gloves to improve your grip on the brush cutter handle. Gloves also reduce the transmission of machine vibration to your hands.

FUEL&OIL MIXTURE



WARNING

- Never fill the fuel tank to the very top.
- Never add fuel to the tank in a closed non-ventilated area.
- Do not add fuel to this unit close to an open fire or sparks.
- Be sure to wipe off spilled fuel before attempting to start engine.
- Do not attempt to refuel a hot engine.

Fuel used for this model is a mixture of unlead gasoline and approved engine lubricant. When mixing gasoline with two-cycle engine oil, use only gasoline which contains NO ETHANOL or METHANOL (Types of Alcohol) Use Branded 91 octane or higher unlead gasoline known to be of good quality. This will help to avoid possible damage to engine fuel lines and other engine parts.



MIXTURE RATIO IS 40:1

GASOLINE-40 PART OIL-1 PART

Fuel mixture at the rate other than 40:1 may cause damage to the engine, ensure mixture ratio is correct.

FUEL

The engine uses two-stroke fuel, a mixture of gasoline and 2-stroke lubricant 40:1.

GASOLINE

Use branded 91 octane or higher unlead gasoline known to be of good quality.

STORING FUEL

Store fuel only in a clean, safe, approved container. Check and follow local ordinances on type and location of storage container.

IMPORTANT

Two-stroke fuel may separate. Shake fuel container thoroughly before each use. Stored fuel ages. Do not mix more fuel than you expect to use within a month.

FUEL AND OIL MIXTURE

Inspect fuel tank making sure that it is clean and fill with fresh fuel. Use a mixture of 40:1.

CUTTING WITH A BLADE

SCYTHING WEEDS. This is cutting by swinging the blade in a level arc. It can quickly clear areas of field grass and weeds. Scything should not be used to cut large, tough weeds or woody growths.



NOTE

Do not use a brush blade to cut trees which exceed a diameter of 1/2 to 3/4 inches.

Scything can be done in both directions, or just in one way which results in the debris being thrown away from you. Use the side of the blade that it is rotating away from you. Tilt down the blade slightly on this same side. You will be hit by some debris if you scythe in both directions. Do not force the blade to cut. Do not change the angle of cut after it has entered the wood. Avoid using any pressure or leverage which could cause the blade to bind or crack.

SAFETY RULES&PRECAUTIONS

WARNING: The cutter area is still dangerous while the machine is coasting to a stop.

Note: Noise and vibration

- 1.The running at low speed can reduce the noise and quiver.
- 2.In order to lower noise, the brush cutter should be operated in an open environment.
- 3.The vibration can be lowered if the handle is grasped firmly.
- 4.In order to avoid disturbing others, the machine should be operated in daytime.
- 5.Wear personal protective equipment, such as gloves and ear protection during the operation.
- 6.The machine is not for professional work and not for long time operation.
- 7.In order to keep the user's fitness and prolong the machine's life, please do not work more than 2 hours in a whole day and don't keep working more than 10 minutes at a time.

DESCRIPTION

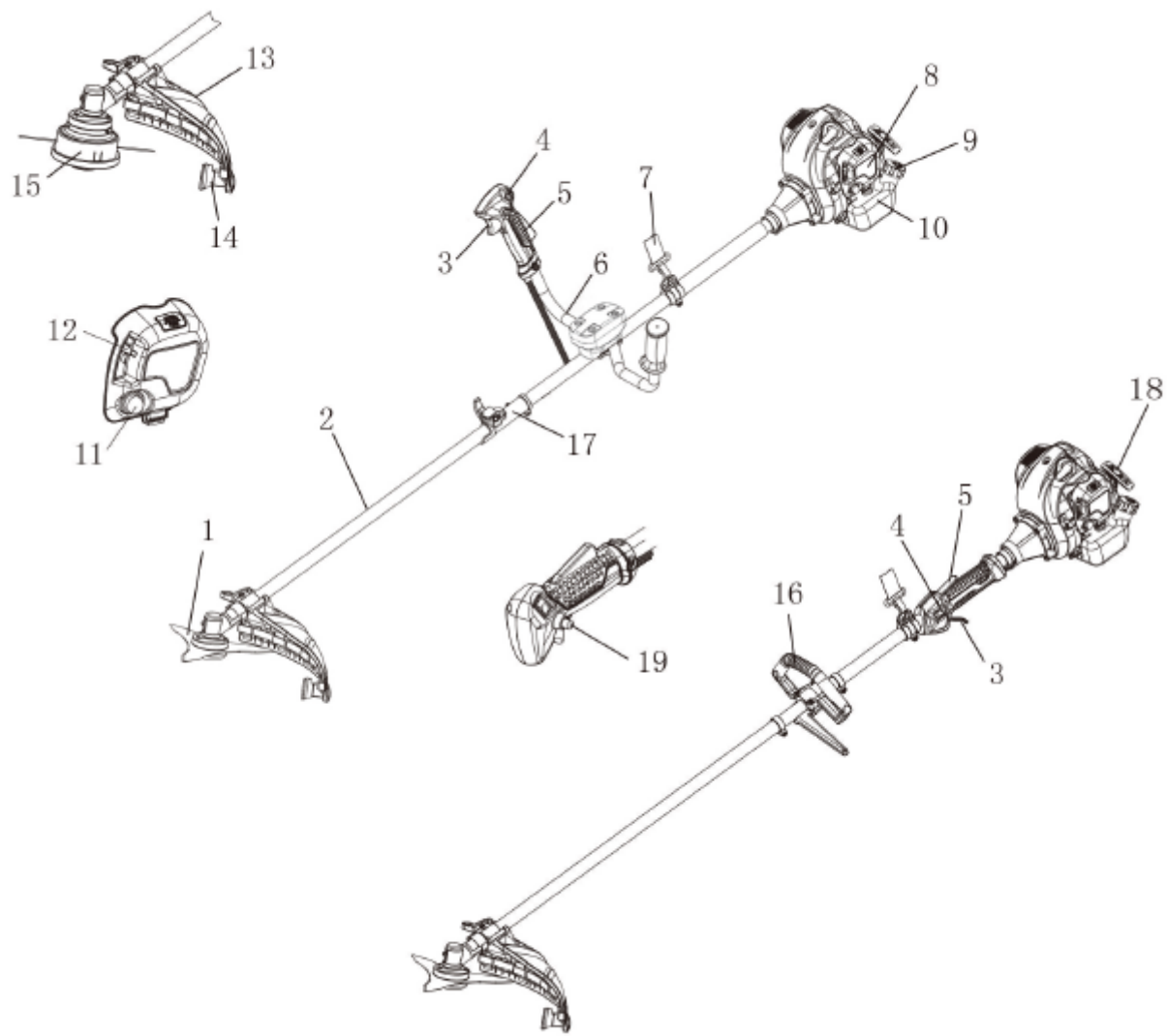

CUTTING WITH A NYLON HEAD

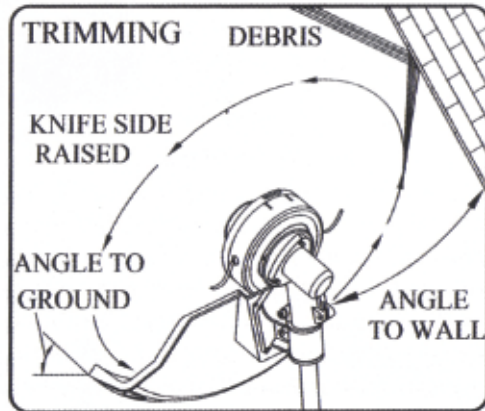

TRIMMING:

This is feeding the trimmer carefully into the material you wish to cut. Tilt the head slowly to direct debris away from you. It' cutting up to a barrier such as fence, wall or tree .approach from an angle where anydebris ricocheting off the barrier will fly away from you. Move the line head slowly until the grass is cut right up the barrier, but do not jam(overfeed)the line into the barrier. If trimming up to a wire mesh or chain linked fence be careful to feed only up to wire. If you go to far the line will snap off around the wire. Trimming can be done to cut through weed stems one at a time. Place the trimmer line head near the bottom of the weed-never high up which could cause the weed to chatter and catch the line. Rather than cut the weed right through, just use the very end of the line to wear through the stem slowly.

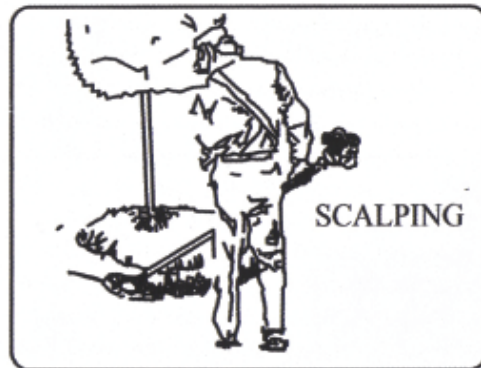

SCALPING AND EDGING:

Both of these are done with the line head tilted at a steep angle scalping is removing top growth leaving the earth bear. Edging is trimming the grass back where it has spread over a sidewalk or drive way. During both edging and scalping, hold the unit a steep angle and in a position where the debris, and any dislodging dirt and stones, will not come back towards you even if it ricochets off the hard surface. Although the picture shows how to edge and scalp every oprator must find for himself the angles which suits his body size and cutting situation.

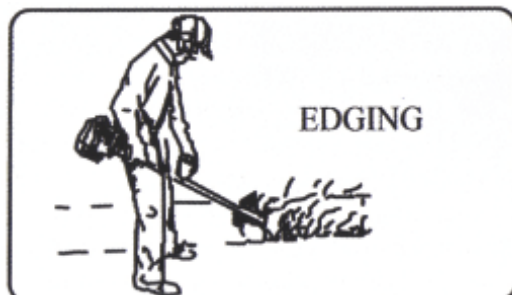

WARNING  DANGER

Do not trim in any area where there are strands of fencing wire, Wear protective safty protecting. Do not cut where you cannot see what the cutting device is cutting.

USING THE SHOULDER HARNESS

1. Assemble and adjust the shoulder harness and belt, as shown.
2. Adjust the shoulder-harness button, and move the hook to your waist, then adjust the belt (if there is a belt).
3. Hang the latch tab on the harness hook.
4. If the brush cutter doesn't balance, then adjust the harness hanger, and the handlebar, until it balances.

WARNING  **CAUTION**

The hook is situated at your right hip, and the quick-release latch is situated at the outside.

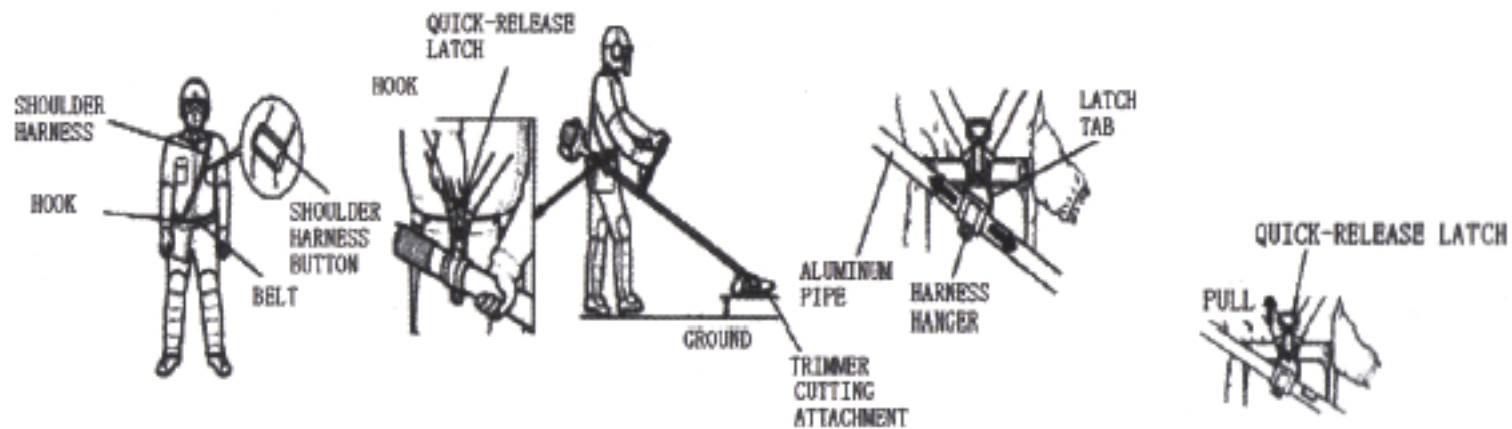

WARNING  **DANGER**

Before using, please check the shoulder harness and confirm it is OK. Encounter danger, please stop the brush cutter immediately, and pull the quick-release latch tab, the brush cutter will be depart from your body.

5. To quickly detach the brush cutter from the harness, pull the quick-release latch tab upward;

6. Insert the latch tongue in the slot of the quick-release latch to reattach the brush cutter to the harness.

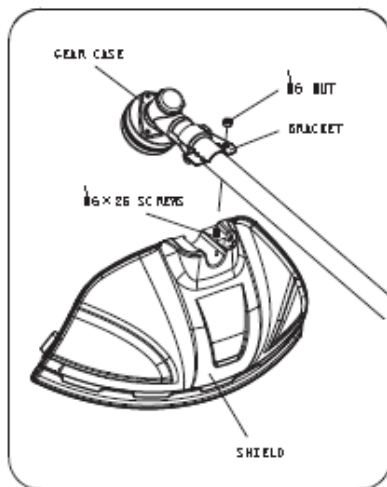

INSTALLING PLASTIC SHIELD

Install the safety cover on the shaft with the safety cover bracket and the screws provided. Tighten the screws after setting the safety cover bracket at the appropriate position.

BLADE INSTALLATION

- Insert the hex key (2) into the specific hole in the angle transmission (3) and rotate the nut (7) by hand until the hex key enters the inner hole, blocking rotation.
- unscrew the nut (7) in a clockwise direction.
- Pull out blade cover (6) and the blade press board(5).
- Ensure that the grooves in the key gasket (4) mach up perfectly with the angle transmisson(3).
- Install the blade (1) and the blade press board(5).
- Refit the blade cover (6) and the nut (7),fully tightening it in an anticlockwise direction.- Remove the hex key (2)

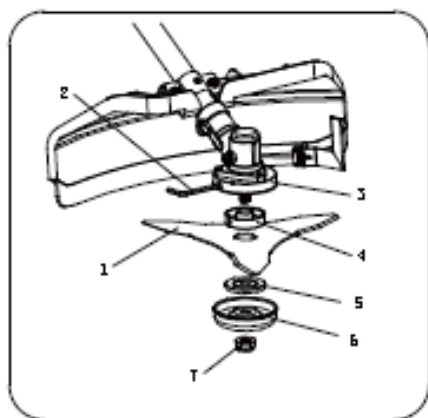

WARNING ! CAUTION

**EXCESSIVE VIBRATION-
STOP ENGINE IMMEDIATELY**
Excessive vibration of blade means that it is not properly installed. Stop engine immediately and check blade. Blade improperly installed will cause injury.
Use only our company original cutting equipment parts when servicing and repairing the unit.

WARNING ! CAUTION

Do not use a steel blade for edging or scalping.

ASSEMBLY

HEAD LINE INSTALLATION

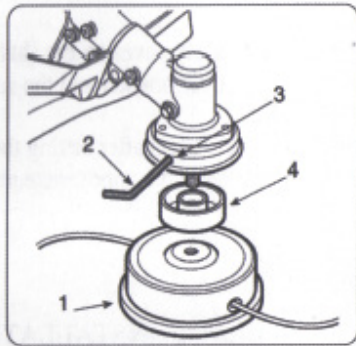

Insert the hex key (2) into the specific hole in the angle transmission (3) and rotate the key gasket (4) by hand until the hex key enters the inner hole, blocking rotation. - Ensure that the grooves in the key gasket (4) mach up perfectly with the angle transmission(3). - Fit the cutting line head (1) screwing it up in an anticlockwise direction. (see from cutting line head)- Remove the hex key (2)

HEAD LINE REPLACEMENT

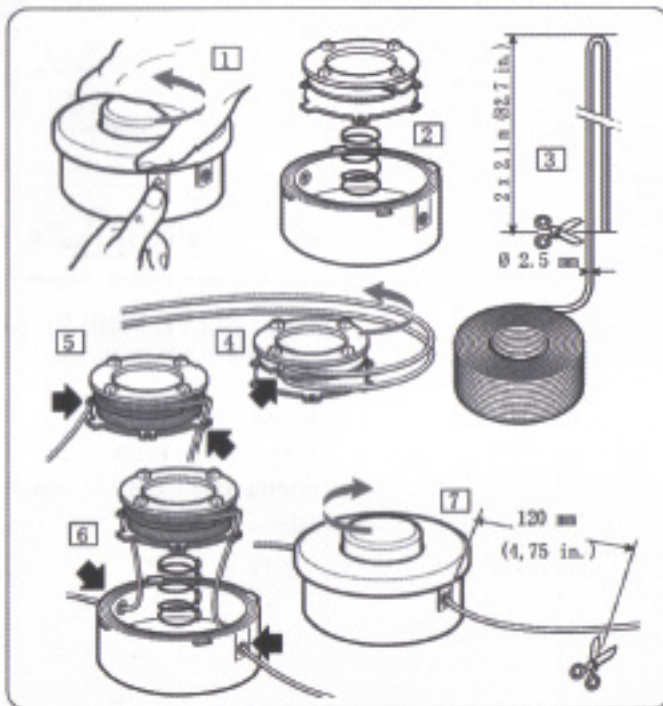

WARNING ! CAUTION

INSTALLING NYLON LINE CUTTER HEAD

Align hole in adapter plate with hole in shaft and install locking tool.
Thread cutter head onto shaft (turning it clockwise) until it is tight.
Remove locking tool.

WARNING ! DANGER

All models trimmers and brushcutters can throw small stone, metal or small objects as well as the material being cut. Read these Rules for Safe Operation with care.
Follow the instructions in your operator's manual.

Read the operator's manual carefully. Be thoroughly familiar with the controls and proper use of the unit. Know how to stop the unit and shut off the engine. Know how to unhook a harnessed unit quickly. Never allow anyone to use the unit without proper instruction. Be sure the operator wears the foot, leg, eye, face and hearing protection. Do not rely on the debris shield on the unit to protect your eyes from ricocheting or thrown objects. Keep the area clear of bystanders, children and pets. Never allow children to operate for play with the unit. Do not allow anyone to enter the operating DANGER ZONE with you. The danger zone is an area 15 meters in radius (about 16 paces) or 50 feet. Insist that persons in the RISK ZONE beyond the danger zone wear eye protection from thrown objects. If the unit must be used where there are unprotected people, operate at a low throttle speed to reduce the risk of thrown objects. Move the stop switch to "stop" position when the engine idles, hereby ensuring it is reliable before cutting. Only may continue to operate the unit when stop switch is in good condition. Routines for checking that the cutting attachment stops turning when the engine idles. Hold the brushcutter with the right hand on the trigger handle and the left hand on the left handle. Keep a firm grip with both hands while in operation. Brush cutter should be held at a comfortable position with the trigger handle about hip height. Maintain your grip and balance on both feet. Position yourself so that you will not be drawn off balance by the kick-back reaction of the cutting blade. Use the shoulder harness at all times. Adjust both harness and harness clamp on the unit so that the unit hangs a few inches above ground level. The cutting head and the plastic debris shield should be level in all directions. Harness the unit on the right side of your body.

WARNING  **DANGER**

In addition to head, eye, face and ear protectors wear shoes to protect your feet and improve your footing on slippery surfaces. Do not wear ties, jewelry, or loose, dangling clothing which could be caught in the unit.

Do not wear open-toed footwear, or go bare-foot or bare legged. In certain situations you must wear total face and head protection.

Pay attention so as not to kick back and blade thrust.

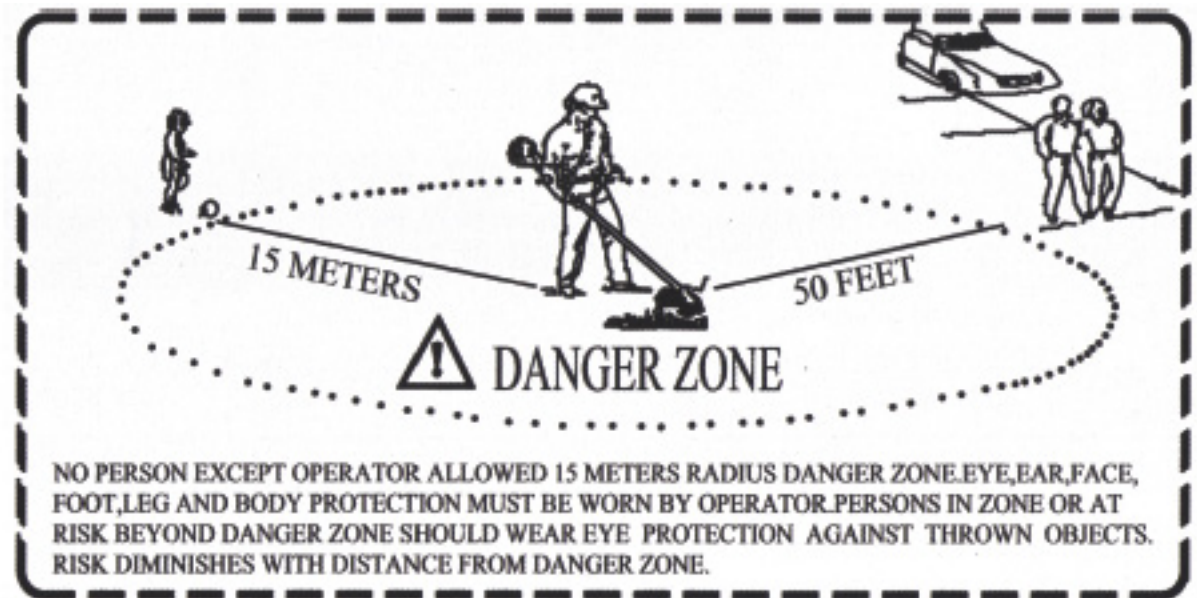

TRANSMISSION DIAGRAM & SPARE PART LIST

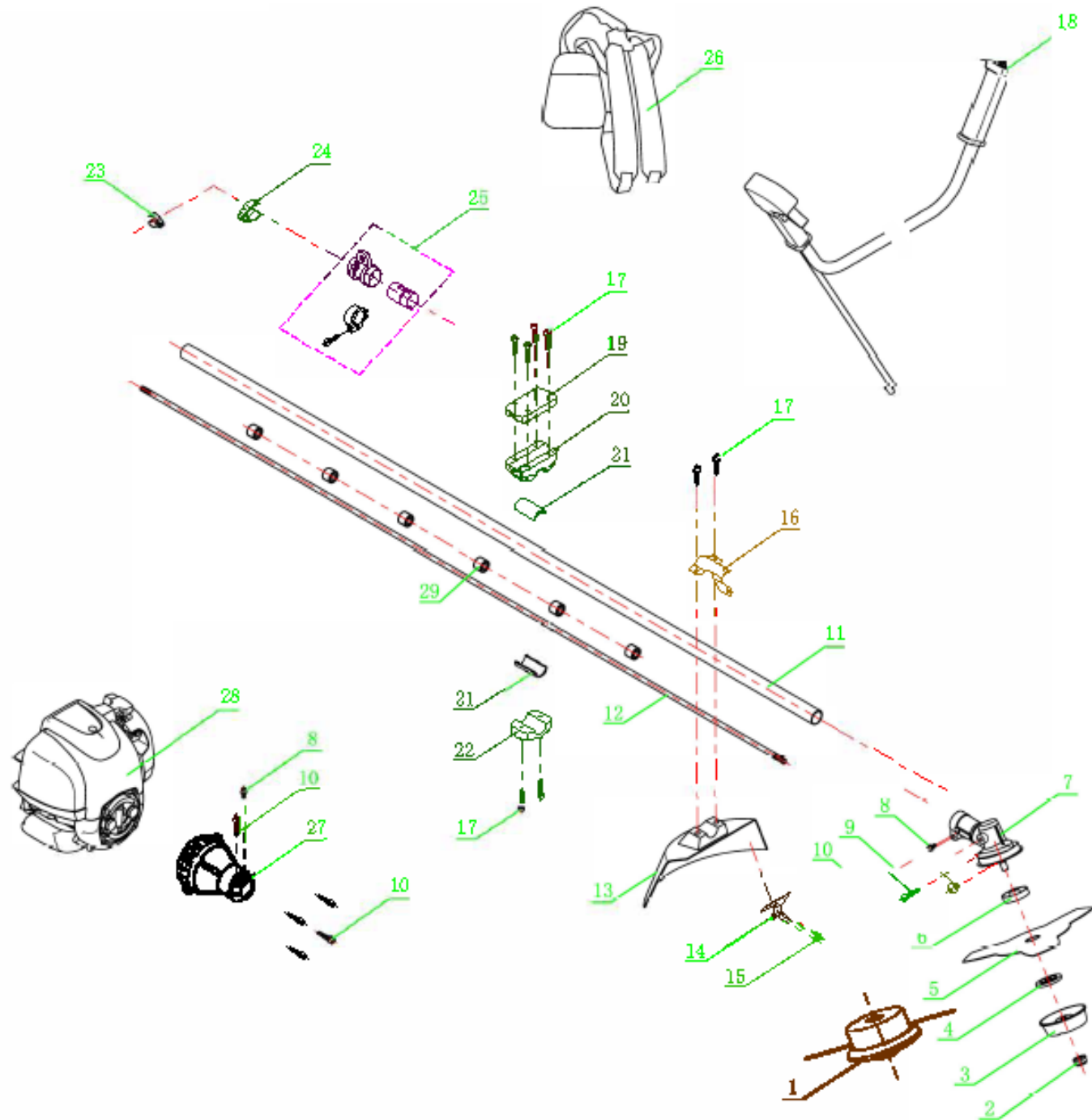

TRANSMISSION DIAGRAM & SPARE PART LIST

| SL NO | PART NO | DESCRIPTION | SL NO | PART NO | DESCRIPTION |
|-------|----------------|------------------|-------|----------------|-------------------------|
| 1 | AM-3000-BC-T01 | Trimmer head | 17 | AM-3000-BC-T17 | Combined screw |
| 2 | AM-3000-BC-T02 | Lock nut | 18 | AM-3000-BC-T18 | Switch handle |
| 3 | AM-3000-BC-T03 | Blade sheild | 19 | AM-3000-BC-T19 | Upper handle base |
| 4 | AM-3000-BC-T04 | Press plate | 20 | AM-3000-BC-T20 | Middle handle base |
| 5 | AM-3000-BC-T05 | 2T Blade | 21 | AM-3000-BC-T21 | Vibration reduce rubber |
| 6 | AM-3000-BC-T06 | Lock Plate | 22 | AM-3000-BC-T22 | Down handle base |
| 7 | AM-3000-BC-T07 | Gear box | 23 | AM-3000-BC-T23 | Cable locker |
| 8 | AM-3000-BC-T08 | Combined screw | 24 | AM-3000-BC-T24 | Cable locker |
| 9 | AM-3000-BC-T09 | Road head screw | 25 | AM-3000-BC-T25 | Belt mountings |
| 10 | AM-3000-BC-T10 | Combined screw | 26 | AM-3000-BC-T26 | Belt |
| 11 | AM-3000-BC-T11 | Shaft | 27 | AM-3000-BC-T27 | Clutch housing |
| 12 | AM-3000-BC-T12 | Nine Teeth shaft | 28 | AM-3000-BC-T28 | Engine |
| 13 | AM-3000-BC-T13 | Grass gurad | 29 | AM-3000-BC-T29 | Oil bearing |
| 14 | AM-3000-BC-T14 | cicular Blade | | | |
| 15 | AM-3000-BC-T15 | Screw | | | |
| 16 | AM-3000-BC-T16 | Press plate | | | |

ENGINE DIAGRAM & PART LIST

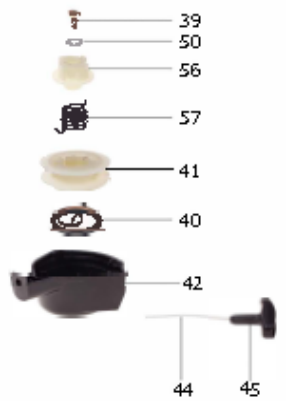
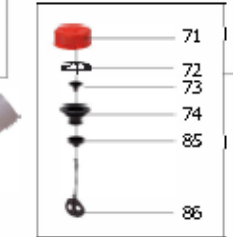
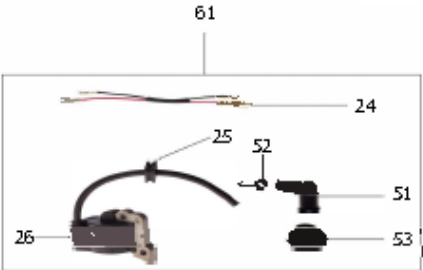
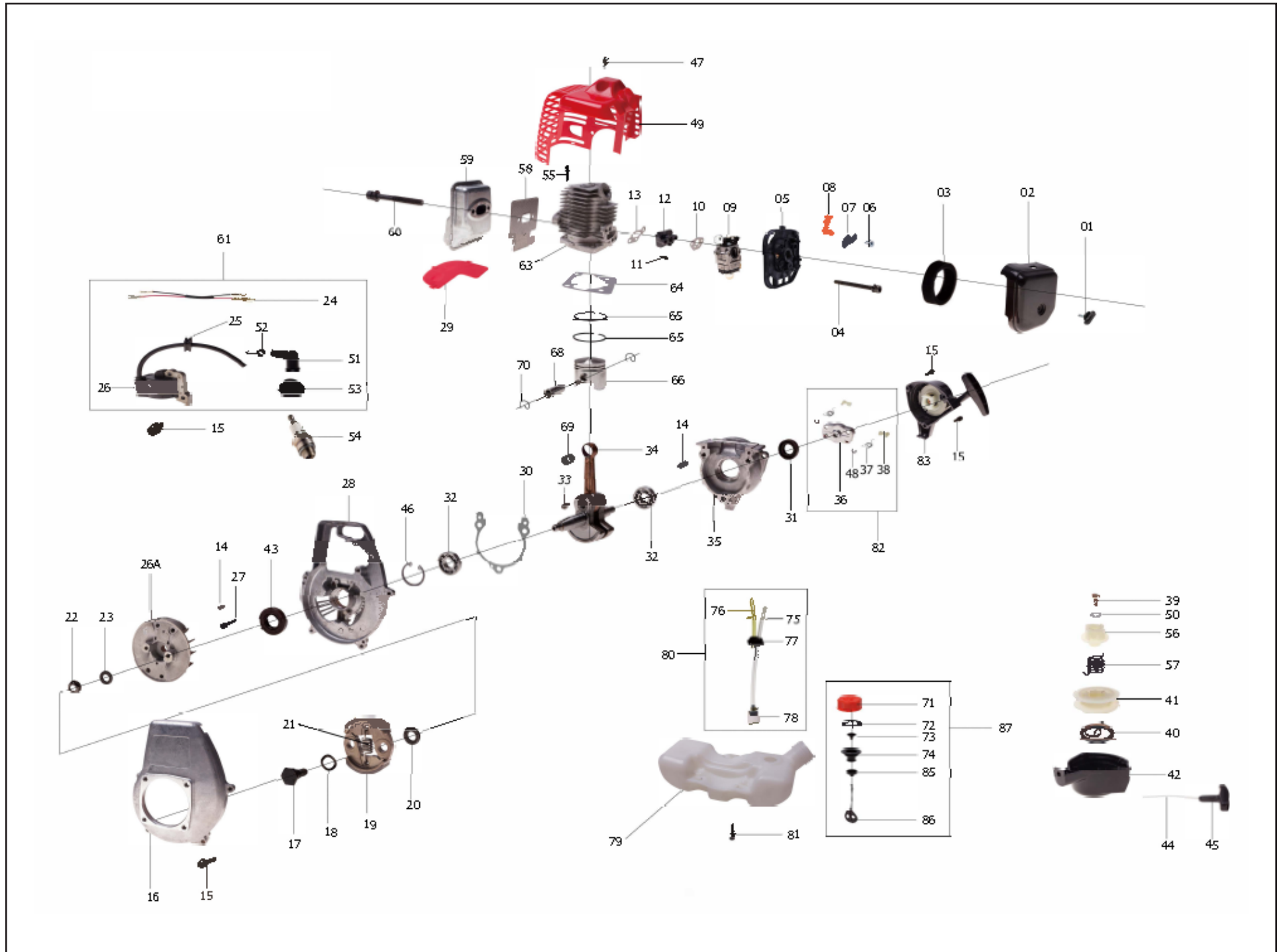

ENGINE DIAGRAM & PART LIST

| SL NO | PART NO | DESCRIPTION | SL NO | PART NO | DESCRIPTION |
|-------|-----------|-------------------------|-------|------------|---------------------|
| 1 | AX-33-E01 | Air filter cover screw | 18 | AX-33-E18 | Saddle washer |
| 2 | AX-33-E02 | Air filter cover | 19 | AX-33-E19 | Clutch housing shoe |
| 3 | AX-33-E03 | Aponge filter | 20 | AX-33-E20 | Washer |
| 4 | AX-33-E04 | Screw | 21 | AX-33-E21 | Spring |
| 5 | AX-33-E05 | Air filter inside cover | 22 | AX-33-E22 | Nut |
| 6 | AX-33-E06 | Screw | 23 | AX-33-E23 | Washer |
| 7 | AX-33-E07 | Choke | 24 | AX-33-E24 | Stop line |
| 8 | AX-33-E08 | Lifting | 25 | AX-33-E25 | Rubber seal |
| 9 | AX-33-E09 | Carburetor | 26 | AX-33-E26 | Ignition |
| 10 | AX-33-E10 | Carburator gasket | 26A | AX-33-E26A | Fly Wheel |
| 11 | AX-33-E11 | Screw | 27 | AX-33-E27 | Screw |
| 12 | AX-33-E12 | Admiting pipe | 28 | AX-33-E28 | Middle crank case |
| 13 | AX-33-E13 | Admiting pipe gasket | 29 | AX-33-E29 | Muffler cover |
| 14 | AX-33-E14 | Pin | 30 | AX-33-E30 | Crank case gasket |
| 15 | AX-33-E15 | Screw | 31 | AX-33-E31 | Oil seal |
| 16 | AX-33-E16 | Crank case cover | 32 | AX-33-E32 | Bearing |
| 17 | AX-33-E17 | Screw pin | | | |





ENGINE DIAGRAM & PART LIST

| SL NO | PART NO | DESCRIPTION | SL NO | PART NO | DESCRIPTION |
|-------|-----------|----------------------|-------|-----------|----------------|
| 33 | AX-33-E33 | Key-Crank Shaft | 49 | AX-33-E49 | Engine cover |
| 34 | AX-33-E34 | Crank Shaft Assy | 50 | AX-33-E50 | Washer |
| 35 | AX-33-E35 | Small Crank Case | 51 | AX-33-E51 | Rubber cap |
| 36 | AX-33-E36 | Start Reel | 52 | AX-33-E52 | Spring |
| 37 | AX-33-E37 | Spring | 53 | AX-33-E53 | Rubber seat |
| 38 | AX-33-E38 | Set forward | 54 | AX-33-E54 | Spark plug |
| 39 | AX-33-E39 | Screw | 55 | AX-33-E55 | Screw |
| 40 | AX-33-E40 | Torsional spring | 56 | AX-33-E56 | Spring seat |
| 41 | AX-33-E41 | Starter inner core | 57 | AX-33-E57 | Spring |
| 42 | AX-33-E42 | Starter cover | 58 | AX-33-E58 | Muffler Gasket |
| 43 | AX-33-E43 | Oil Seal | 59 | AX-33-E59 | Muffler |
| 44 | AX-33-E44 | Starter rope | 60 | AX-33-E60 | Screw |
| 45 | AX-33-E45 | Starter pully handle | 61 | AX-33-E61 | Ignition assy |
| 46 | AX-33-E46 | Jump Ring | 62 | AX-33-E62 | NA |
| 47 | AX-33-E47 | Screw | 63 | AX-33-E63 | Cyliner |
| 48 | AX-33-E48 | Spring retainer | 64 | AX-33-E64 | Cyliner gasket |

| SL NO | PART NO | DESCRIPTION | SL NO | PART NO | DESCRIPTION |
|-------|-----------|----------------------|-------|-----------|-------------------------|
| 65 | AX-33-E65 | Piston ring | 76 | AX-33-E76 | Gasoline discharge pipe |
| 66 | AX-33-E66 | Piston | 77 | AX-33-E77 | Seal |
| 67 | AX-33-E67 | NA | 78 | AX-33-E78 | Filter |
| 68 | AX-33-E68 | Piston pin | 79 | AX-33-E79 | Fuel tank |
| 69 | AX-33-E69 | Bearing | 80 | AX-33-E80 | Fuel tank pipe assy |
| 70 | AX-33-E70 | Piston clip | 81 | AX-33-E81 | Screw |
| 71 | AX-33-E71 | Cap | 82 | AX-33-E82 | Start Reel assy |
| 72 | AX-33-E72 | Seal | 83 | AX-33-E83 | Starter assy |
| 73 | AX-33-E73 | Breather valve | 84 | AX-33-E84 | NA |
| 74 | AX-33-E74 | Rubber seal | 85 | AX-33-E85 | Seal cap |
| 75 | AX-33-E75 | Gasoline intake pipe | 86 | AX-33-E86 | Anti-tripping lanyard |





WARRANTY CARD

CUSTOMER COPY

| | | | |
|-----------------------------------------------------------------------------------|-----------------------------------------------------------------------------------------------------|-------------------------------------------------------------------------------------|--------------------|
| DATE _____ | DATE OF DELIVERY _____ | DEALERS OFFICIAL SEAL | DEALERS SIGN _____ |
| PURCHASERS NAME & ADDRESS _____ _____ |  CUSTOMER SIGN |  | |
| PRODUCT NAME | PRODUCT SERIAL NO. | INVOICE/DN NO. | |
|  |  |  | |





I/Will accept the terms and conditions of warranty as in the warranty card

DEALERS COPY

| | | | |
|-----------------------------------------------------------------------------------|-----------------------------------------------------------------------------------------------------|-------------------------------------------------------------------------------------|--------------------|
| DATE _____ | DATE OF DELIVERY _____ | DEALERS OFFICIAL SEAL | DEALERS SIGN _____ |
| PURCHASERS NAME & ADDRESS _____ _____ |  CUSTOMER SIGN |  | |
| PRODUCT NAME | PRODUCT SERIAL NO. | INVOICE/DN NO. | |
|  |  |  | |

I/Will accept the terms and conditions of warranty as in the warranty card

COMPANY COPY

| | | | |
|-------------------------------------------------------------------------------------|-------------------------------------------------------------------------------------------------------|---------------------------------------------------------------------------------------|--------------------|
| DATE _____ | DATE OF DELIVERY _____ | DEALERS OFFICIAL SEAL | DEALERS SIGN _____ |
| PURCHASERS NAME & ADDRESS _____ _____ |  CUSTOMER SIGN |  | |
| PRODUCT NAME | PRODUCT SERIAL NO. | INVOICE/DN NO. | |
|  |  |  | |

I/Will accept the terms and conditions of warranty as in the warranty card

1. LIMITED WARRANTY PERIOD : For a period of six months from the date of Sale / delivery of the product which ever is earlier. 2. LIMITED WARRANTY OBLIGATION : Replacement of defective part(s) by authorized dealer are free of charges. If found defective by reasons of defective material / poor workmanship, parts will be replaced and there will be no value re-imburement. 3. TERMS & CONDITIONS : a. Claims under warranty will be accepted on submission of Warranty Card duly filled and stamped by authorized dealer together with the original purchase document. : b. Shipping / transportation / Incidental charges incurred in replacing defective parts under warranty shall be borne by the purchaser

WARRANTY null & void if

- (i) Lack of maintenance, (ii) Incorrect use of the machine or tampering, (iii) Use of non-genuine spare parts, (iv) Usage of acids, solvents, or any flammable materials, (v) Non-usage of filter water / clear water / soft water & using water above 40°C temperature, (vi) While using the pressure washers to draw water which is contaminated with dust & solvents (eg. paint thinners, gasoline, oil, etc.), (vii) Repair done by unauthorized service people, (viii) Those parts subject to wear & tear due to normal operations and plastic parts, rubber items etc, (ix) Loose connections, faulty electrical fixtures & fluctuations in power supply.
- 4. Should any failure occur during or after the warranty period, customer does not have the right to interrupt payment / price discount.
- 5. Incidental or consequential damages like inconvenience commercial loss, loss of tie, mental agony etc.
- 6. Loss of any nature due to operation or non-operation is not covered under warranty.
- 7. All free service are at Dealer's service point only.
- 8. Warranty ceases if service is not done periodically.
- 9. The attached card should be completed and returned to Ratnagiri Impex Pvt. Ltd. for registration immediately after sale / delivery.
- 10. The warranty is void unless you register the warranty card with Ratnagiri Impex Pvt. Ltd.
- 11. The decision of Ratnagiri Impex Pvt. Ltd., in settling the warranty is final in all respects.
- 12. All disputes are subject to Bangalore Courts Jurisdiction

1. LIMITED WARRANTY PERIOD : For a period of six months from the date of Sale / delivery of the product which ever is earlier. 2. LIMITED WARRANTY OBLIGATION : Replacement of defective part(s) by authorized dealer are free of charges. If found defective by reasons of defective material / poor workmanship, parts will be replaced and there will be no value re-imburement. 3. TERMS & CONDITIONS : a. Claims under warranty will be accepted on submission of Warranty Card duly filled and stamped by authorized dealer together with the original purchase document. : b. Shipping / transportation / Incidental charges incurred in replacing defective parts under warranty shall be borne by the purchaser.

WARRANTY null & void if

- (i) Lack of maintenance, (ii) Incorrect use of the machine or tampering, (iii) Use of non-genuine spare parts, (iv) Usage of acids, solvents, or any flammable materials, (v) Non-usage of filter water / clear water / soft water & using water above 40°C temperature, (vi) While using the pressure washers to draw water which is contaminated with dust & solvents (eg. paint thinners, gasoline, oil, etc.), (vii) Repair done by unauthorized service people, (viii) Those parts subject to wear & tear due to normal operations and plastic parts, rubber items etc, (ix) Loose connections, faulty electrical fixtures & fluctuations in power supply.
- 4. Should any failure occur during or after the warranty period, customer does not have the right to interrupt payment / price discount.
- 5. Incidental or consequential damages like inconvenience commercial loss, loss of tie, mental agony etc.
- 6. Loss of any nature due to operation or non-operation is not covered under warranty.
- 7. All free service are at Dealer's service point only.
- 8. Warranty ceases if service is not done periodically.
- 9. The attached card should be completed and returned to Ratnagiri Impex Pvt. Ltd. for registration immediately after sale / delivery.
- 10. The warranty is void unless you register the warranty card with Ratnagiri Impex Pvt. Ltd.
- 11. The decision of Ratnagiri Impex Pvt. Ltd., in settling the warranty is final in all respects.
- 12. All disputes are subject to Bangalore Courts Jurisdiction

1. LIMITED WARRANTY PERIOD : For a period of six months from the date of Sale / delivery of the product which ever is earlier. 2. LIMITED WARRANTY OBLIGATION : Replacement of defective part(s) by authorized dealer are free of charges. If found defective by reasons of defective material / poor workmanship, parts will be replaced and there will be no value re-imburement. 3. TERMS & CONDITIONS : a. Claims under warranty will be accepted on submission of Warranty Card duly filled and stamped by authorized dealer together with the original purchase document. : b. Shipping / transportation / Incidental charges incurred in replacing defective parts under warranty shall be borne by the purchaser.

WARRANTY null & void if

- (i) Lack of maintenance, (ii) Incorrect use of the machine or tampering, (iii) Use of non-genuine spare parts, (iv) Usage of acids, solvents, or any flammable materials, (v) Non-usage of filter water / clear water / soft water & using water above 40°C temperature, (vi) While using the pressure washers to draw water which is contaminated with dust & solvents (eg. paint thinners, gasoline, oil, etc.), (vii) Repair done by unauthorized service people, (viii) Those parts subject to wear & tear due to normal operations and plastic parts, rubber items etc, (ix) Loose connections, faulty electrical fixtures & fluctuations in power supply.
- 4. Should any failure occur during or after the warranty period, customer does not have the right to interrupt payment / price discount.
- 5. Incidental or consequential damages like inconvenience commercial loss, loss of tie, mental agony etc.
- 6. Loss of any nature due to operation or non-operation is not covered under warranty.
- 7. All free service are at Dealer's service point only.
- 8. Warranty ceases if service is not done periodically.
- 9. The attached card should be completed and returned to Ratnagiri Impex Pvt. Ltd. for registration immediately after sale / delivery.
- 10. The warranty is void unless you register the warranty card with Ratnagiri Impex Pvt. Ltd.
- 11. The decision of Ratnagiri Impex Pvt. Ltd., in settling the warranty is final in all respects.
- 12. All disputes are subject to Bangalore Courts Jurisdiction



FREE SERVICE COUPON (30DAYS/30HRS. WHICHEVER IS EARLIER)

MODEL

SERIAL NUMBER

PDI DATE

SERVICE NO.

PURCHASE BILL NO.

DATE

DEALERS OFFICE SEAL

- 1. Check and test the fuel mixture
- 3. Check , clean and adjust the spark plug
- 5. Check and sparken the cutting tools
- 7. Start and check the noise, vibration, loosen etc..

OPERATIONS

- 2. check and clean the air filter
- 4. Check and adjust the carburetor tuning
- 6. Product familirisation on usage
- 8. Routine maintenance and shortage.

FREE SERVICE COUPON (30DAYS/30HRS. WHICHEVER IS EARLIER)

MODEL

SERIAL NUMBER

PDI DATE

SERVICE NO.

PURCHASE BILL NO.

DATE

DEALERS OFFICE SEAL

- 1. Check and test the fuel mixture
- 3. Check , clean and adjust the spark plug
- 5. Check and sparken the cutting tools
- 7. Start and check the noise, vibration, loosen etc..

OPERATIONS

- 2. check and clean the air filter
- 4. Check and adjust the carburetor tuning
- 6. Product familirisation on usage
- 8. Routine maintenance and shortage.

FREE SERVICE COUPON (30DAYS/30HRS. WHICHEVER IS EARLIER)

MODEL

SERIAL NUMBER

PDI DATE

SERVICE NO.

PURCHASE BILL NO.

DATE

DEALERS OFFICE SEAL

- 1. Check and test the fuel mixture
- 3. Check , clean and adjust the spark plug
- 5. Check and sparken the cutting tools
- 7. Start and check the noise, vibration, loosen etc..

OPERATIONS

- 2. check and clean the air filter
- 4. Check and adjust the carburetor tuning
- 6. Product familirisation on usage
- 8. Routine maintenance and shortage.

DOS

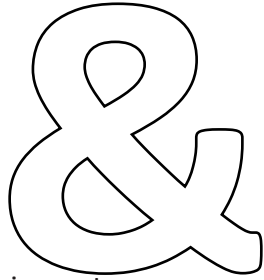

DONT'S

attempting to use the equipments.

1. Always read the instruction manual supplied along with the equipments and understand the correct installation and operating procedures before

trousers and jackets while operating potentially dangerous machines
2. It is important to use the personal protection equipments such as head helmet with visor, ear defenders, goggles, safety gloves, cut resistant shoes,
3. Avoid untrained persons using the equipments. Children must not be allowed to handle these equipments
4. Always use genuine spares and accessories in repairs and usage to derive maximum life of the equipments.
5. Always keep the equipments in good working condition to minimize loss of output as well as to reduce the pollution and save the environment
6. Do not use the machine within range of persons unless they wear protective clothing
7. Do not operate the machine when fatigued or under the influence of alcohol or drugs
8. For more query kindly contact for our Service Center/Dealer/ franchise

NO. 1 CHOICE OF FARMERS SINCE 1999



Marketed by.
**ratnagiri
impex**
BRINGING YOU THE FUTURE... NOW

RATNAGIRI IMPEX PVT., LTD.,

Annapurna House, #1 / 1G, 7th Cross, New
Guddadahalli

Mysore Road, Bangalore - 560 026

Missed Call : 7393 938 938

Email: ask@agrimart.in