

HTP HIGH PRESSURE SPRAYER

AM-30FSK/30K AM-30-PRO

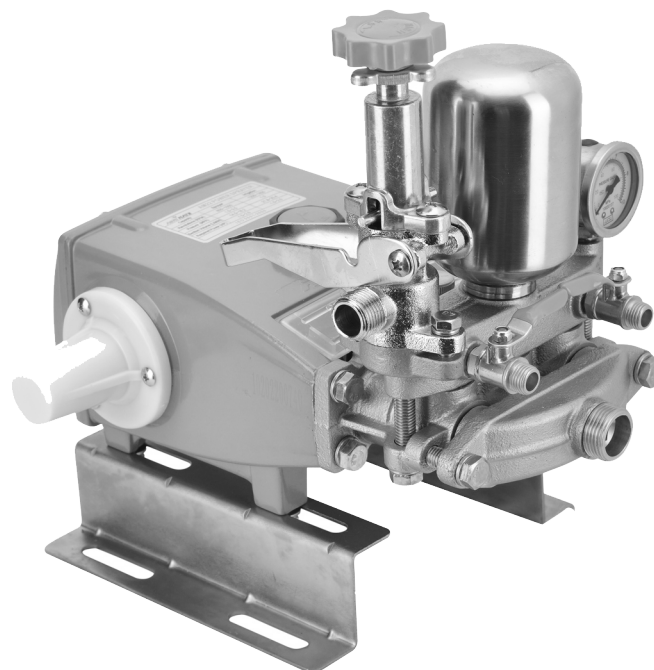

INTRODUCTION

1. Check every fasteners and make sure that the sprayer and the motor are installed firmly on the frame.
2. Set the two pullies in a straight-line, and the belt in an appropriate tightness
3. Every joint of the hoses must be tightened to prevent from leaking
4. Before starting the motor, shut off the (43) cock(valve) loose the (56) pressure adjusting screw and pull the (59) pressure adjuster to the top
5. Start the motor to power the sprayer, keep a proper revolution, press the (59) pressure adjuster to the bottom. Keep the pressure around 21-35Kgs by adjusting the (56) pressure adjusting screw.
6. Open the (43) cock valve to start spraying
7. Alter the spraying is over. Pul the (59) pressure adjuster to the top and operate the sprayer with fresh water to clean out the remaining chemicals.
8. Replace the engine oil after the sprayer has been used for the first 10 hours, 50 hours, and then every 100 hours.
9. Drain away the dirty engine oil by screwing off the (5) drain plug

AM-30FSK/30K SPARE PARTS DIAGRAM

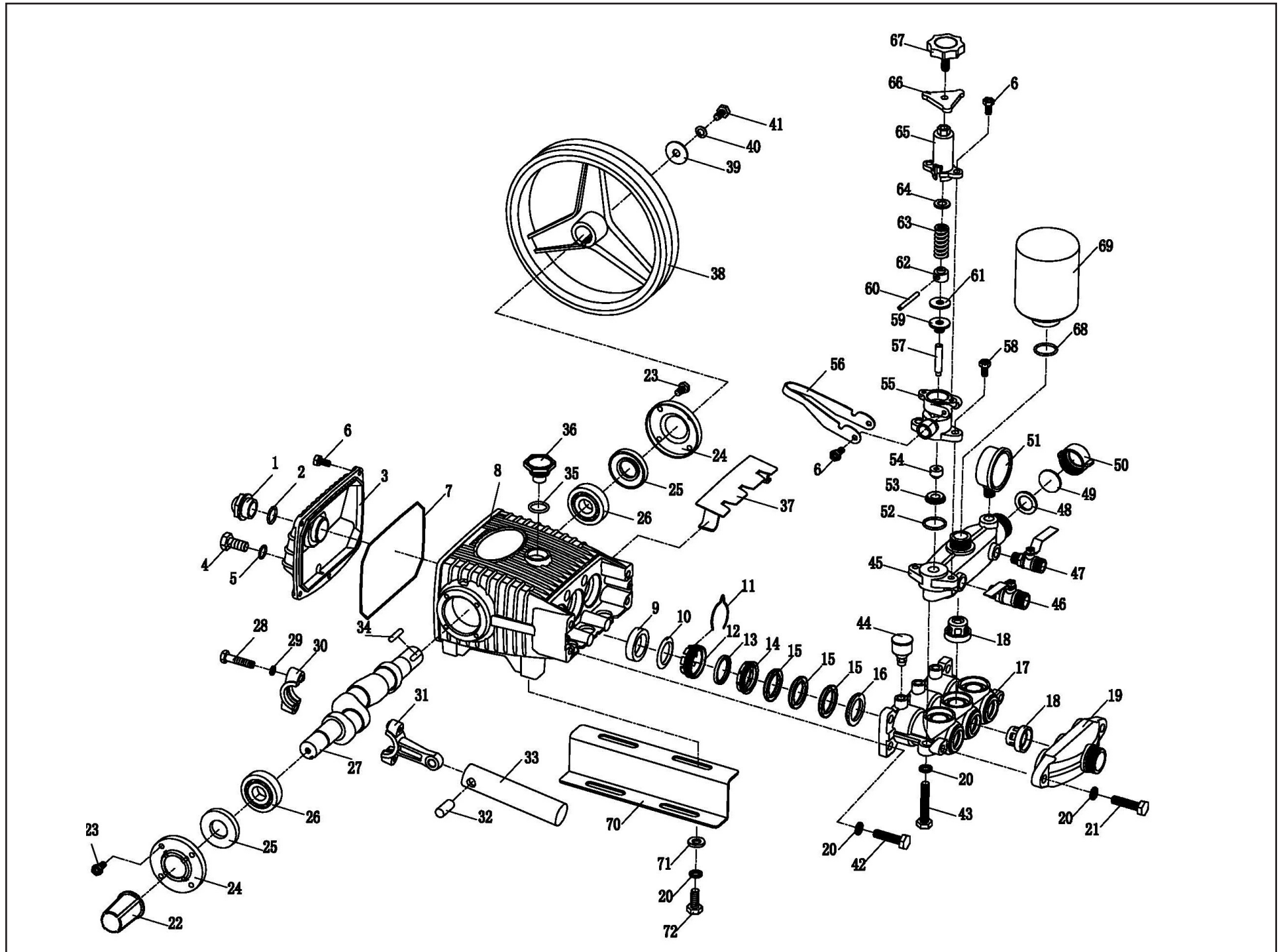

SPARE PARTS LIST OF AM-30FSK/30K HTP HIGH PRESSURE SPRAYER

SL NO	PART NO	DESCRIPTION	SL NO	PART NO	DESCRIPTION
1	AM-30FSK/30K-01	Oil Gas	17	AM-30FSK/30K-17	Cylinder
2	AM-30FSK/30K-02	O-Ring	18	AM-30FSK/30K-18	Valve
3	AM-30FSK/30K-03	Crankcase Cover	19	AM-30FSK/30K-19	Suction metal
4	AM-30FSK/30K-04	Plug Drain	20	AM-30FSK/30K-20	Washer spring
5	AM-30FSK/30K-05	O-Ring	21	AM-30FSK/30K-21	Bolt
6	AM-30FSK/30K-06	Bolt	30	AM-30FSK/30K-30	Cover oil seal
7	AM-30FSK/30K-07	Crankcase Gasket	23	AM-30FSK/30K-23	Bolt
8	AM-30FSK/30K-08	Crankcase	24	AM-30FSK/30K-24	Cover oil seal
9	AM-30FSK/30K-09	Plunger oil seal	25	AM-30FSK/30K-25	Crankshaft oil seal
10	AM-30FSK/30K-10	stopping ring water	26	AM-30FSK/30K-26	Bearing
11	AM-30FSK/30K-11	Circlip	27	AM-30FSK/30K-27	Crankshaft
12	AM-30FSK/30K-12	Grand	28	AM-30FSK/30K-28	Bolt
13	AM-30FSK/30K-13	Grease seal	29	AM-30FSK/30K-29	Washer spring
14	AM-30FSK/30K-14	Grease Ring	30	AM-30FSK/30K-30	Connecting Rod
15	AM-30FSK/30K-15	V- Packing	31	AM-30FSK/30K-31	Pin
16	AM-30FSK/30K-16	V- packing seat	32	AM-30FSK/30K-32	

SPARE PARTS LIST OF AM-30FSK/30K HTP HIGH PRESSURE SPRAYER

SL NO	PART NO	DESCRIPTION	SL NO	PART NO	DESCRIPTION
33	AM-30FSK/30K-33	Plunger	49	AM-30FSK/30K-49	Gasket
34	AM-30FSK/30K-34	Pin	50	AM-30FSK/30K-50	Coupling
35	AM-30FSK/30K-35	O-Ring	51	AM-30FSK/30-51	Pressure guage
36	AM-30FSK/30K-36	Plunger cover	52	AM-30FSK/30K-52	O-ring
37	AM-30FSK/30K-37	Plug	53	AM-30FSK/30K-53	Valve seat
38	AM-30FSK/30K-38	Pulley	54	AM-30FSK/30K-54	Valve plug
39	AM-30FSK/30K-39	Washer	55	AM-30FSK/30K-55	Body overflow
40	AM-30FSK30K-40	washer spring	56	AM-30FSK/30K-56	Knob control
41	AM-30FSK/30K-41	Bolt	57	AM-30FSK/30K-57	Spindle
42	AM-30FSK/30K-42	Bolt	58	AM-30FSK/30K-58	Bolt
43	AM-30FSK/30K-43	Bolt	59	AM-30FSK/30K-59	Seat
44	AM-30FSK/30K-44	Grease Cup	60	AM-30FSK/30K-60	Pin
45	AM-30FSK/30K-45	Discharge metal	61	AM-30FSK/30K-61	Flat Gasket
46	AM-30FSK30K-46	Cock	62	AM-30FSK/30K-62	Spring washer
47	AM-30FSK/30K-47	Cock	63	AM-30FSK/30K-63	Spring
48	AM-30FSK/30K-48	Washer	64	AM-30FSK/30K-64	Seat

AM-30 PRO SPARE PARTS DIAGRAM

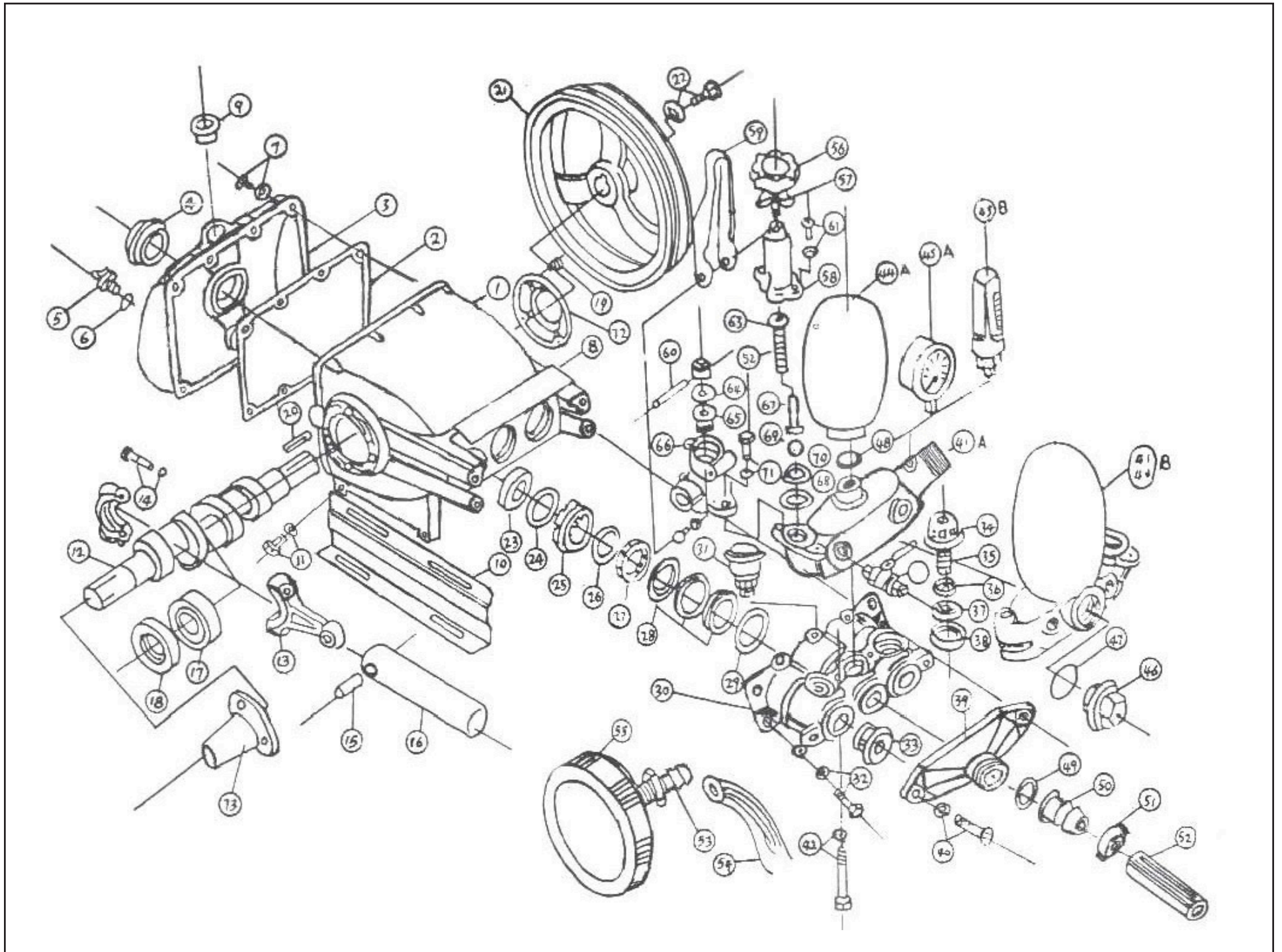

SPARE PARTS LIST OF AM-30 PRO HTP SPRAYER





SL NO	PART NO	DESCRIPTION	SL NO	PART NO	DESCRIPTION
1	AM30P-01	Oil Gas	17	AM30P-17	Cylinder
2	AM30P-02	O-Ring	18	AM30P-18	Valve
3	AM30P-03	Crankcase Cover	19	AM30P-19	Suction metal
4	AM30P-04	Plug Drain	20	AM30P-20	Washer spring
5	AM30P-05	O-Ring	21	AM30P-21	Bolt
6	AM30P-06	Bolt	30	AM30P-22	Cover oil seal
7	AM30P-07	Crankcase Gasket	23	AM30P-23	Bolt
8	AM30P-08	Crankcase	24	AM30P-24	Cover oil seal
9	AM30P-09	Plunger oil seal	25	AM30P-25	Crankshaft oil seal
10	AM30P-10	stopping ring water	26	AM30P-26	Bearing
11	AM30P-11	Circlip	27	AM30P-27	Crankshaft
12	AM30P-12	Grand	28	AM30P-28	Bolt
13	AM30P-13	Grease seal	29	AM30P-29	Washer spring
14	AM30P-14	Grease Ring	30	AM30P-30	Connecting Rod
15	AM30P-15	V- Packing	31	AM30P-31	
16	AM30P-16	V- packing seat	32	AM30P-32	Pin

SPARE PARTS LIST OF AM-30 PRO HTP SPRAYER

SL NO	PART NO	DESCRIPTION	SL NO	PART NO	DESCRIPTION
33	AM30P-33	Plunger	49	AM30P-49	Gasket
34	AM30P-34	Pin	50	AM30P-50	Coupling
35	AM30P-35	O-Ring	51	AM30P-51	Pressure guage
36	AM30P-36	Plunger cover	52	AM30P-52	O-ring
37	AM30P-37	Plug	53	AM30P-53	Valve seat
38	AM30P-38	Pulley	54	AM30P-54	Valve plug
39	AM30P-39	Washer	55	AM30P-55	Body overflow
40	AM30P-40	washer spring	56	AM30P-56	Knob control
41	AM30P-41	Bolt	57	AM30P-57	Spindle
42	AM30P-42	Bolt	58	AM30P-58	Bolt
43	AM30P-43	Bolt	59	AM30P-59	Seat
44	AM30P-44	Grease Cup	60	AM30P-60	Pin
45	AM30P-45	Discharge metal	61	AM30P-61	Flat Gasket
46	AM30P-46	Cock	62	AM30P-62	Spring washer
47	AM30P-47	Cock	63	AM30P-63	Spring
48	AM30P-48	Washer	64	AM30P-64	Seat





WARRANTY CARD

CUSTOMER COPY

DATE _____	DATE OF DELIVERY _____	DEALERS OFFICIAL SEAL	DEALERS SIGN _____
PURCHASERS NAME & ADDRESS _____ _____	 CUSTOMER SIGN		
PRODUCT NAME	PRODUCT SERIAL NO.	INVOICE/DN NO.	
			

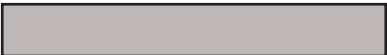



I/Will accept the terms and conditions of warranty as in the warranty card

DEALERS COPY

DATE _____	DATE OF DELIVERY _____	DEALERS OFFICIAL SEAL	DEALERS SIGN _____
PURCHASERS NAME & ADDRESS _____ _____	 CUSTOMER SIGN		
PRODUCT NAME	PRODUCT SERIAL NO.	INVOICE/DN NO.	
			

I/Will accept the terms and conditions of warranty as in the warranty card

COMPANY COPY

DATE _____	DATE OF DELIVERY _____	DEALERS OFFICIAL SEAL	DEALERS SIGN _____
PURCHASERS NAME & ADDRESS _____ _____	 CUSTOMER SIGN		
PRODUCT NAME	PRODUCT SERIAL NO.	INVOICE/DN NO.	
			

I/Will accept the terms and conditions of warranty as in the warranty card

1. LIMITED WARRANTY PERIOD : For a period of six months from the date of Sale / delivery of the product which ever is earlier. 2. LIMITED WARRANTY OBLIGATION : Replacement of defective part(s) by authorized dealer are free of charges. If found defective by reasons of defective material / poor workmanship, parts will be replaced and there will be no value re-imburement. 3. TERMS & CONDITIONS : a. Claims under warranty will be accepted on submission of Warranty Card duly filled and stamped by authorized dealer together with the original purchase document. : b. Shipping / transportation / Incidental charges incurred in replacing defective parts under warranty shall be borne by the purchaser

WARRANTY null & void if

- (i) Lack of maintenance, (ii) Incorrect use of the machine or tampering, (iii) Use of non-genuine spare parts, (iv) Usage of acids, solvents, or any flammable materials, (v) Non-usage of filter water / clear water / soft water & using water above 40°C temperature, (vi) While using the pressure washers to draw water which is contaminated with dust & solvents (eg. paint thinners, gasoline, oil, etc.), (vii) Repair done by unauthorized service people, (viii) Those parts subject to wear & tear due to normal operations and plastic parts, rubber items etc, (ix) Loose connections, faulty electrical fixtures & fluctuations in power supply.
- 4. Should any failure occur during or after the warranty period, customer does not have the right to interrupt payment / price discount.
- 5. Incidental or consequential damages like inconvenience commercial loss, loss of tie, mental agony etc.
- 6. Loss of any nature due to operation or non-operation is not covered under warranty.
- 7. All free service are at Dealer's service point only.
- 8. Warranty ceases if service is not done periodically.
- 9. The attached card should be completed and returned to Ratnagiri Impex Pvt. Ltd. for registration immediately after sale / delivery.
- 10. The warranty is void unless you register the warranty card with Ratnagiri Impex Pvt. Ltd.
- 11. The decision of Ratnagiri Impex Pvt. Ltd., in settling the warranty is final in all respects.
- 12. All disputes are subject to Bangalore Courts Jurisdiction

1. LIMITED WARRANTY PERIOD : For a period of six months from the date of Sale / delivery of the product which ever is earlier. 2. LIMITED WARRANTY OBLIGATION : Replacement of defective part(s) by authorized dealer are free of charges. If found defective by reasons of defective material / poor workmanship, parts will be replaced and there will be no value re-imburement. 3. TERMS & CONDITIONS : a. Claims under warranty will be accepted on submission of Warranty Card duly filled and stamped by authorized dealer together with the original purchase document. : b. Shipping / transportation / Incidental charges incurred in replacing defective parts under warranty shall be borne by the purchaser.

WARRANTY null & void if

- (i) Lack of maintenance, (ii) Incorrect use of the machine or tampering, (iii) Use of non-genuine spare parts, (iv) Usage of acids, solvents, or any flammable materials, (v) Non-usage of filter water / clear water / soft water & using water above 40°C temperature, (vi) While using the pressure washers to draw water which is contaminated with dust & solvents (eg. paint thinners, gasoline, oil, etc.), (vii) Repair done by unauthorized service people, (viii) Those parts subject to wear & tear due to normal operations and plastic parts, rubber items etc, (ix) Loose connections, faulty electrical fixtures & fluctuations in power supply.
- 4. Should any failure occur during or after the warranty period, customer does not have the right to interrupt payment / price discount.
- 5. Incidental or consequential damages like inconvenience commercial loss, loss of tie, mental agony etc.
- 6. Loss of any nature due to operation or non-operation is not covered under warranty.
- 7. All free service are at Dealer's service point only.
- 8. Warranty ceases if service is not done periodically.
- 9. The attached card should be completed and returned to Ratnagiri Impex Pvt. Ltd. for registration immediately after sale / delivery.
- 10. The warranty is void unless you register the warranty card with Ratnagiri Impex Pvt. Ltd.
- 11. The decision of Ratnagiri Impex Pvt. Ltd., in settling the warranty is final in all respects.
- 12. All disputes are subject to Bangalore Courts Jurisdiction

1. LIMITED WARRANTY PERIOD : For a period of six months from the date of Sale / delivery of the product which ever is earlier. 2. LIMITED WARRANTY OBLIGATION : Replacement of defective part(s) by authorized dealer are free of charges. If found defective by reasons of defective material / poor workmanship, parts will be replaced and there will be no value re-imburement. 3. TERMS & CONDITIONS : a. Claims under warranty will be accepted on submission of Warranty Card duly filled and stamped by authorized dealer together with the original purchase document. : b. Shipping / transportation / Incidental charges incurred in replacing defective parts under warranty shall be borne by the purchaser.

WARRANTY null & void if

- (i) Lack of maintenance, (ii) Incorrect use of the machine or tampering, (iii) Use of non-genuine spare parts, (iv) Usage of acids, solvents, or any flammable materials, (v) Non-usage of filter water / clear water / soft water & using water above 40°C temperature, (vi) While using the pressure washers to draw water which is contaminated with dust & solvents (eg. paint thinners, gasoline, oil, etc.), (vii) Repair done by unauthorized service people, (viii) Those parts subject to wear & tear due to normal operations and plastic parts, rubber items etc, (ix) Loose connections, faulty electrical fixtures & fluctuations in power supply.
- 4. Should any failure occur during or after the warranty period, customer does not have the right to interrupt payment / price discount.
- 5. Incidental or consequential damages like inconvenience commercial loss, loss of tie, mental agony etc.
- 6. Loss of any nature due to operation or non-operation is not covered under warranty.
- 7. All free service are at Dealer's service point only.
- 8. Warranty ceases if service is not done periodically.
- 9. The attached card should be completed and returned to Ratnagiri Impex Pvt. Ltd. for registration immediately after sale / delivery.
- 10. The warranty is void unless you register the warranty card with Ratnagiri Impex Pvt. Ltd.
- 11. The decision of Ratnagiri Impex Pvt. Ltd., in settling the warranty is final in all respects.
- 12. All disputes are subject to Bangalore Courts Jurisdiction



FREE SERVICE COUPON (30DAYS/30HRS. WHICHEVER IS EARLIER)

MODEL

SERIAL NUMBER

PDI DATE

SERVICE NO.

PURCHASE BILL NO.

DATE

DEALERS OFFICE SEAL

- 1. Check and test the fuel mixture
- 3. Check , clean and adjust the spark plug
- 5. Check and sparken the cutting tools
- 7. Start and check the noise, vibration, loosen etc..

OPERATIONS

- 2. check and clean the air filter
- 4. Check and adjust the carburetor tuning
- 6. Product familirisation on usage
- 8. Routine maintenance and shortage.

FREE SERVICE COUPON (30DAYS/30HRS. WHICHEVER IS EARLIER)

MODEL

SERIAL NUMBER

PDI DATE

SERVICE NO.

PURCHASE BILL NO.

DATE

DEALERS OFFICE SEAL

- 1. Check and test the fuel mixture
- 3. Check , clean and adjust the spark plug
- 5. Check and sparken the cutting tools
- 7. Start and check the noise, vibration, loosen etc..

OPERATIONS

- 2. check and clean the air filter
- 4. Check and adjust the carburetor tuning
- 6. Product familirisation on usage
- 8. Routine maintenance and shortage.

FREE SERVICE COUPON (30DAYS/30HRS. WHICHEVER IS EARLIER)

MODEL

SERIAL NUMBER

PDI DATE

SERVICE NO.

PURCHASE BILL NO.

DATE

DEALERS OFFICE SEAL

- 1. Check and test the fuel mixture
- 3. Check , clean and adjust the spark plug
- 5. Check and sparken the cutting tools
- 7. Start and check the noise, vibration, loosen etc..

OPERATIONS

- 2. check and clean the air filter
- 4. Check and adjust the carburetor tuning
- 6. Product familirisation on usage
- 8. Routine maintenance and shortage.

DOS

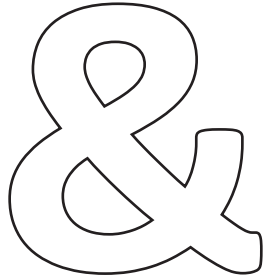

DONT'S

1. Always read the instruction manual supplied along with the equipments and understand the correct installation and operating procedures before attempting to use the equipments.
2. It is important to use the personal protection equipments such as head helmet with visor, ear defenders, goggles, safety gloves, cut resistant shoes, trousers and jackets while operating potentially dangerous machines
3. Avoid untrained persons using the equipments. Children must not be allowed to handle these equipments
4. Always use genuine spares and accessories in repairs and usage to derive maximum life of the equipments.
5. Always keep the equipments in good working condition to minimize loss of output as well as to reduce the pollution and save the environment
6. Do not use the machine within range of persons unless they wear protective clothing
7. Do not operate the machine when fatigued or under the influence of alcohol or drugs
8. When the machine is running, please maintain a constant water supply. Without water circulation will damage the sealing rings of the machine.
9. For more query kindly contact for our Service Center/Dealer/ franchise

Agrimate Army For Pest Control

ANY WHERE - ANY TIME - ANY CROP

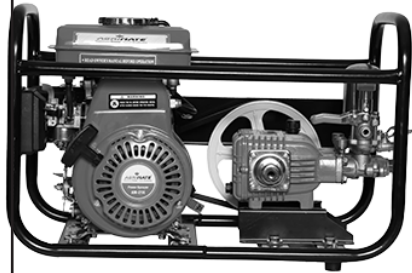
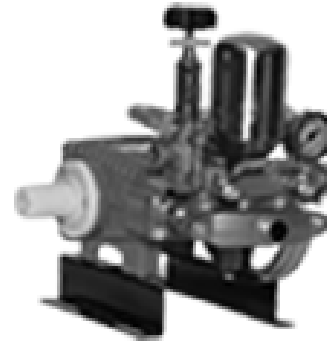

Marketed by:
**ratnagiri
impex**
BRINGING YOU THE FUTURE... NOW

RATNAGIRI IMPEX PVT., LTD.,

Annapurna House, #1 / 1G, 7th Cross, New
Guddadahalli

Mysore Road, Bangalore - 560 026

Missed Call : 7393 938 938

Email: ask@agrimart.in