

User Manual

AM CHAMPION BATTERY SPRAYER



BEFORE OPERATING THIS MACHINE,
PLEASE READ THESE INSTRUCTIONS CAREFULLY

DISCLAIMER: DUE TO CONSTANT UPGRADATION, FEATURES AND SPECIFICATIONS ARE SUBJECT TO CHANGE WITHOUT NOTICE

1. Each time after using this sprayer, it must be charged to maintain inside power and to avoid short working life
2. When doing charge or discharge, please assure that you have switched off the power to avoid to wasting electricity.
3. After using sprayer. It should be recharged, If not using the sprayer for long time, please charge the battery approx. once in a month to retain life-span of battery.
4. After using sprayer. Please keep outside and inside of sprayer clean.
5. Keep the sprayer in the shady place. Don't store the sprayer under direct sunlight.
6. Please keep no residue of insecticide, fertilizer or herbicide at bottom of tank, keep bottom dry so as to avoid corrosion.

SAFETY WARNING

If you are using the sprayer with hazardous or poisonous liquid, use only with directions supplied by the manufacturer of the hazardous or poisonous liquid. Please clean the sprayer thoroughly after use.

Note: Please clean tank inside by clear water after spraying each time. Please using filter when put into water.

STORE: Please clean the pump, then charge 10-15 hours, keep it at day shady place.

WARNING: Don't let battery without power, otherwise it can't charge next time. As battery with self discharge function, please recharge after two or three months.

EXAMINATION

Problem	Cause	Remedies
1. DC Motor Doesn't work	No Power or loose plug	Charge or check plug
2. Automatic stop during spraying	Overheat damaged intelligent controller	Pause then continue spraying after cooling down
3. No water Sprayers, Nozzle	Jammed Nozzle Air in hose	Clean nozzle Check hose tighten, release air
Instable water Pressure	Jammed Pump Broken hose	Check pump clean eye winker Change new one
Lower Pressure and smaller flux	Jammed filter in hose Jammed filter in sprayer switch Lower Voltage	Clean filter Clean Filter Change new one
Leakage in tie – in	Loose tie-in Broken O ring	Tighten Screw Check new one
Sprayer doesn't work well	Jammed nozzle Broken Sprayer core	Clean eye winker Change new One
Pump Motor starts then cut sometimer when stop spray	Eye winker in the Switch Rubber Seal Hose Leakage at the pump	Open and clean Tighten Tighten

TECHNICAL SPECIFICATION

Model	AM CHAMPION
Name	Battery Sprayer
Tank Capacity	16L
Pump Rate	3.6 L
Battery	8AH with regulator
Lance	Telescopic SS

DIAGRAM OF AM CHAMPION - BATTERY SPRAYER

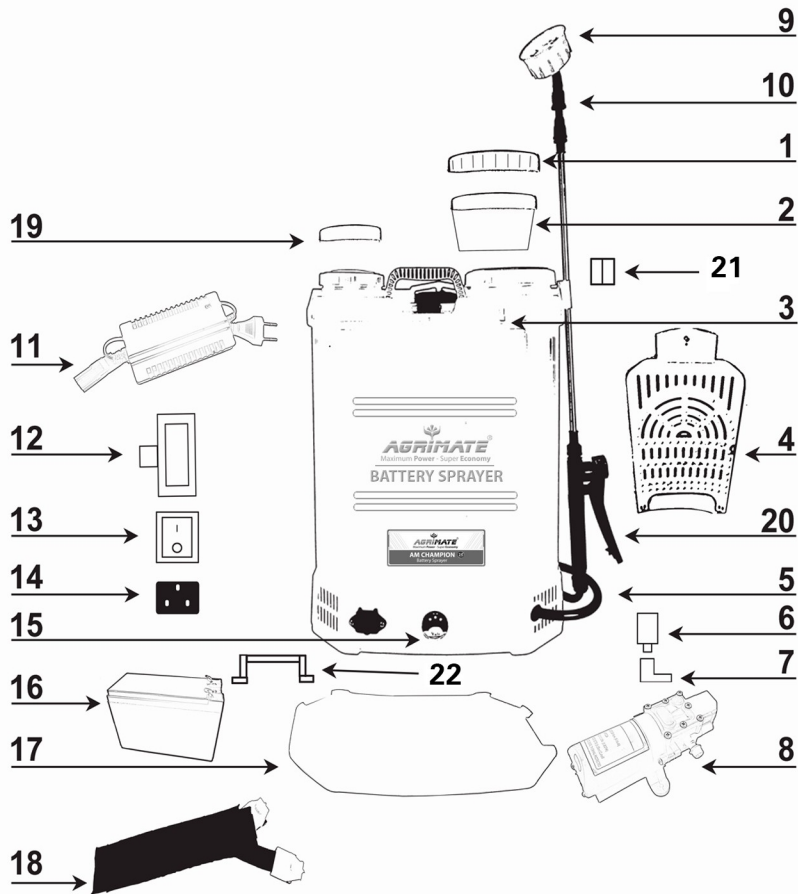

AM CHAMPION SPRAYER - SPARE PARTS

Part No.	Description
AM-CHAMPION-01	Tank cap
AM-CHAMPION-02	Strainer
AM-CHAMPION-03	Tank
AM-CHAMPION-04	Backrest
AM-CHAMPION-05	Hose
AM-CHAMPION-06	Inner filter
AM-CHAMPION-07	Elbow
AM-CHAMPION-08	Auto pump
AM-CHAMPION-09	8 holes nozzle
AM-CHAMPION-9.1	Fan nozzle
AM-CHAMPION-9.2	4 holes nozzle
AM-CHAMPION-9.3	Adjustable nozzle
AM-CHAMPION-10	Extensive ss lance
AM-CHAMPION-11	1.3A Charger
AM-CHAMPION-12	Regulator
AM-CHAMPION-13	On/off switch
AM-CHAMPION-14	Charging socket
AM-CHAMPION-15	Volt meter
AM-CHAMPION-16	12V/8AH battery
AM-CHAMPION-17	Bottom plate
AM-CHAMPION-18	Belt
AM-CHAMPION-19	Side small cap
AM-CHAMPION-20	Trigger
AM-CHAMPION-21	Lance clip
AM-CHAMPION-22	Battery clip

SPARE PARTS DIAGRAM & LIST OF AM CHAMPION



AM CHAMPION-01
Tank cap



AM CHAMPION-02
Strainer



AM CHAMPION-04
Backrest



AM CHAMPION-05
Hose



AM CHAMPION-06
Inner filter



AM CHAMPION-07
Elbow



AM CHAMPION-08
Auto pump



AM CHAMPION-09
8 holes nozzle



AM CHAMPION-9.1
Fan nozzle



AM CHAMPION-9.2
4 holes nozzle



AM CHAMPION-9.3
Adjustable nozzle



AM CHAMPION-10
Extensive ss lance



AM CHAMPION-11
1.3A Charger



AM CHAMPION-12
Regulator

SPARE PARTS DIAGRAM & LIST OF AM CHAMPION



AM CHAMPION-13
On/off switch



AM CHAMPION-14
Charging socket



AM CHAMPION-15
Volt meter



AM CHAMPION-16
12V/8AH battery



AM CHAMPION-17
Bottom plate



AM CHAMPION-18
Belt



AM CHAMPION-19
Side small cap



AM CHAMPION-20
Trigger



AM CHAMPION-21
Lance clip



AM CHAMPION-22
Battery clip

INSPECTION & MAINTENANCE

For safety use, make sure the machine is cleaned every three-months. Before working, make sure to inspect the filter and the nozzle, and ensure there is no impurity. After working, make sure there is no water in the pump and the hose.

If the machine needs to be repaired in the guarantee period, please return the machine to the shop. You need to provide the certificate of purchase in order to repair or get the substitute.

Before Packing, the machine should be cleaned, then use closed packaging, packaging should be firm. Store the machine in dry place.

For transportation safety. The machine should comply with ISTA.



Meaning of crossed - out wheeled dustbin:

Do not dispose of electrical machines as unsorted municipal waste, use separate collection facilities.

If electrical machines are disposed of in landfills or dumps, hazardous substances can leak into the groundwater and get into the food chain, damaging your health and well-being.

When replacing old machines with new ones, the retailer is legally obligated to take back your old machine for disposals at least free of charge.

Warranty Card

CUSTOMER COPY



Purchaser's Name & Address

Product Name

AM-CHAMPION BATTERY SPRAYER

Product Serial No.

Invoice / DN No.

Date of Delivery

Dealer's Office Seal

Dealer Sign _____

Customer Sign. _____

I/We accept the terms and conditions of Warranty as in the Warranty Card.

Warranty Card

DEALER'S COPY



Purchaser's Name & Address

Product Name

AM-CHAMPION BATTERY SPRAYER

Product Serial No.

Invoice / DN No.

Date of Delivery

Dealer's Office Seal

Dealer Sign _____

Customer Sign. _____

I/We accept the terms and conditions of Warranty as in the Warranty Card.

Warranty Card

COMPANY COPY



Purchaser's Name & Address

Product Name

AM-CHAMPION BATTERY SPRAYER

Product Serial No.

Invoice / DN No.

Date of Delivery

Dealer's Office Seal

Dealer Sign _____

Customer Sign. _____

I/We accept the terms and conditions of Warranty as in the Warranty Card.

1. **LIMITED WARRANTY PERIOD** : For a period of six months from the date of Sale / delivery of the product which ever is earlier. 2. **LIMITED WARRANTY OBLIGATION** : Replacement of defective part(s) by authorized dealer are free of charges. If found defective by reasons of defective material / poor workmanship, parts will be replaced and there will be no value re-imbursalment. 3. **TERMS & CONDITIONS** : a. Claims under warranty will be accepted on submission of Warranty Card duly filled and stamped by authorized dealer together with the original purchase document . b. Shipping / transportation / Incidental charges incurred in replacing defective parts under warranty shall be borne by the purchaser.

WARRANTY null & void if

- (i) Lack of maintenance, (ii) Incorrect use of the machine or tampering, (iii) Use of non-genuine spare parts, (iv) Usage of acids, solvents, or any flammable materials, (v) Non-usage of filter water / clear water / soft water & using water above 40°C temperature, (vi) While using the pressure washers to draw water which is contaminated with dust & solvents (eg. paint thinners, gasoline, oil, etc.), (vii) Repair done by unauthorized service people, (viii) Those parts subject to wear & tear due to normal operations and plastic parts, rubber items etc, (ix) Loose connections, faulty electrical fixtures & fluctuations in power supply.
4. Should any failure occur during or after the warranty period, customer does not have the right to interrupt payment / price discount.
 5. Incidental or consequential damages like inconvenience commercial loss, loss of tie, mental agony etc.
 6. Loss of any nature due to operation or non-operation is not covered under warranty.
 7. All free service are at Dealer's service point only.
 8. Warranty ceases if service is not done periodically.
 9. The attached card should be completed and returned to Ratnagiri Impex Pvt. Ltd. for registration immediately after sale / delivery.
 10. The warranty is void unless you register the warranty card with Ratnagiri Impex Pvt. Ltd.
 11. The decision of Ratnagiri Impex Pvt. Ltd., in settling the warranty is final in all respects.
 12. All disputes are subject to Bangalore Courts Jurisdiction

1. **LIMITED WARRANTY PERIOD** : For a period of six months from the date of Sale / delivery of the product which ever is earlier. 2. **LIMITED WARRANTY OBLIGATION** : Replacement of defective part(s) by authorized dealer are free of charges. If found defective by reasons of defective material / poor workmanship, parts will be replaced and there will be no value re-imbursalment. 3. **TERMS & CONDITIONS** : a. Claims under warranty will be accepted on submission of Warranty Card duly filled and stamped by authorized dealer together with the original purchase document . b. Shipping / transportation / Incidental charges incurred in replacing defective parts under warranty shall be borne by the purchaser.

WARRANTY null & void if

- (i) Lack of maintenance, (ii) Incorrect use of the machine or tampering, (iii) Use of non-genuine spare parts, (iv) Usage of acids, solvents, or any flammable materials, (v) Non-usage of filter water / clear water / soft water & using water above 40°C temperature, (vi) While using the pressure washers to draw water which is contaminated with dust & solvents (eg. paint thinners, gasoline, oil, etc.), (vii) Repair done by unauthorized service people, (viii) Those parts subject to wear & tear due to normal operations and plastic parts, rubber items etc, (ix) Loose connections, faulty electrical fixtures & fluctuations in power supply.
4. Should any failure occur during or after the warranty period, customer does not have the right to interrupt payment / price discount.
 5. Incidental or consequential damages like inconvenience commercial loss, loss of tie, mental agony etc.
 6. Loss of any nature due to operation or non-operation is not covered under warranty.
 7. All free service are at Dealer's service point only.
 8. Warranty ceases if service is not done periodically.
 9. The attached card should be completed and returned to Ratnagiri Impex Pvt. Ltd. for registration immediately after sale / delivery.
 10. The warranty is void unless you register the warranty card with Ratnagiri Impex Pvt. Ltd.
 11. The decision of Ratnagiri Impex Pvt. Ltd., in settling the warranty is final in all respects.
 12. All disputes are subject to Bangalore Courts Jurisdiction

1. **LIMITED WARRANTY PERIOD** : For a period of six months from the date of Sale / delivery of the product which ever is earlier. 2. **LIMITED WARRANTY OBLIGATION** : Replacement of defective part(s) by authorized dealer are free of charges. If found defective by reasons of defective material / poor workmanship, parts will be replaced and there will be no value re-imbursalment. 3. **TERMS & CONDITIONS** : a. Claims under warranty will be accepted on submission of Warranty Card duly filled and stamped by authorized dealer together with the original purchase document . b. Shipping / transportation / Incidental charges incurred in replacing defective parts under warranty shall be borne by the purchaser.

WARRANTY null & void if

- (i) Lack of maintenance, (ii) Incorrect use of the machine or tampering, (iii) Use of non-genuine spare parts, (iv) Usage of acids, solvents, or any flammable materials, (v) Non-usage of filter water / clear water / soft water & using water above 40°C temperature, (vi) While using the pressure washers to draw water which is contaminated with dust & solvents (eg. paint thinners, gasoline, oil, etc.), (vii) Repair done by unauthorized service people, (viii) Those parts subject to wear & tear due to normal operations and plastic parts, rubber items etc, (ix) Loose connections, faulty electrical fixtures & fluctuations in power supply.
4. Should any failure occur during or after the warranty period, customer does not have the right to interrupt payment / price discount.
 5. Incidental or consequential damages like inconvenience commercial loss, loss of tie, mental agony etc.
 6. Loss of any nature due to operation or non-operation is not covered under warranty.
 7. All free service are at Dealer's service point only.
 8. Warranty ceases if service is not done periodically.
 9. The attached card should be completed and returned to Ratnagiri Impex Pvt. Ltd. for registration immediately after sale / delivery.
 10. The warranty is void unless you register the warranty card with Ratnagiri Impex Pvt. Ltd.
 11. The decision of Ratnagiri Impex Pvt. Ltd., in settling the warranty is final in all respects.
 12. All disputes are subject to Bangalore Courts Jurisdiction



1st Free Service Coupon

ISO 9001-2015
CERTIFIED COMPANY

FREE SERVICE COUPON (30Days / 30 hrs (Which ever is earlier))

Model
AM-CHAMPION BATTERY SPRAYER

Serial Number

PDI Date

Purchase bill no.

Date

Service No.

Dealer's Office Seal

Dealer Signature.....

Customer Signature.....

Conditions: Operations listed have been performed to my entire satisfaction without any labour charges. Only consumables were charged.



agriculture | horticulture | sericulture | plantations | forestry | garden | health care

WARRANTY AND FREE SERVICE COUPON



2nd Free Service Coupon

ISO 9001-2015
CERTIFIED COMPANY

FREE SERVICE COUPON (60Days / 60 hrs (Which ever is earlier))

Model
AM-CHAMPION BATTERY SPRAYER

Serial Number

PDI Date

Purchase bill no.

Date

Service No.

Dealer's Office Seal

Dealer Signature.....

Customer Signature.....

Conditions: Operations listed have been performed to my entire satisfaction without any labour charges. Only consumables were charged.



agriculture | horticulture | sericulture | plantations | forestry | garden | health care

WARRANTY AND FREE SERVICE COUPON



3rd Free Service Coupon

ISO 9001-2015
CERTIFIED COMPANY

FREE SERVICE COUPON (90Days /120hrs (Which ever is earlier))

Model
AM-CHAMPION BATTERY SPRAYER

Serial Number

PDI Date

Purchase bill no.

Date

Service No.

Dealer's Office Seal

Dealer Signature.....

Customer Signature.....

Conditions: Operations listed have been performed to my entire satisfaction without any labour charges. Only consumables were charged.



agriculture | horticulture | sericulture | plantations | forestry | garden | health care

WARRANTY AND FREE SERVICE COUPON



Small Maintenance. Big Savings.



Small Maintenance. Big Savings.



Small Maintenance. Big Savings.

Do's & Don'ts

- Always read the instruction manual supplied along with the equipments and understand the correct installation and operating procedures before attempting to use the equipments.
- It is important to use the personal protection equipments such as head helmet with visor, ear defenders, goggles, safety gloves, cut resistant shoes, trousers and jackets while operating potentially dangerous machines.
- Avoid untrained persons using the equipments. Children must not be allowed to handle these equipments.
- Always use genuine spares and accessories in repairs and usage to derive maximum life of the equipments.
- Always keep the equipments in good working condition to minimise loss of output as well as to reduce the pollution and save the environment.
- Do not use the machine within range of persons unless they wear protective clothing.
- Do not operate the machine when fatigued or under the influence of alcohol or drugs.
- When the machine is running, please maintain a constant water supply. Without water circulation will damage the sealing rings of the machine.
- For more query kindly contact for our Service Center/Dealer/ franchise

Agrimate Army For Pest Control

ANY WHERE - ANY TIME - ANY CROP

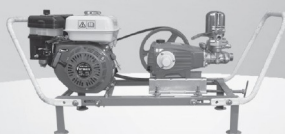

AGRIMATE[®]
Maximum Power - Super Economy

Imported & Marketed by
RATNAGIRI IMPEX PVT LTD
Annapurna House, #1/1G, 7th Cross, New Guddadahalli
Mysore Road, Bangalore-560 026
Customer Care: 1800-425-3036
email: info@ratnagiriimpex.com



Marketed By
 **ratnagiri**[®]
impex
BRINGING YOU THE FUTURE... NOW

www.ratnagiriimpex.com

AN ISO 9001:2015 CERTIFIED COMPANY

